

SET IN MSIM E 1602 AC 2-2 IRE K1006.1

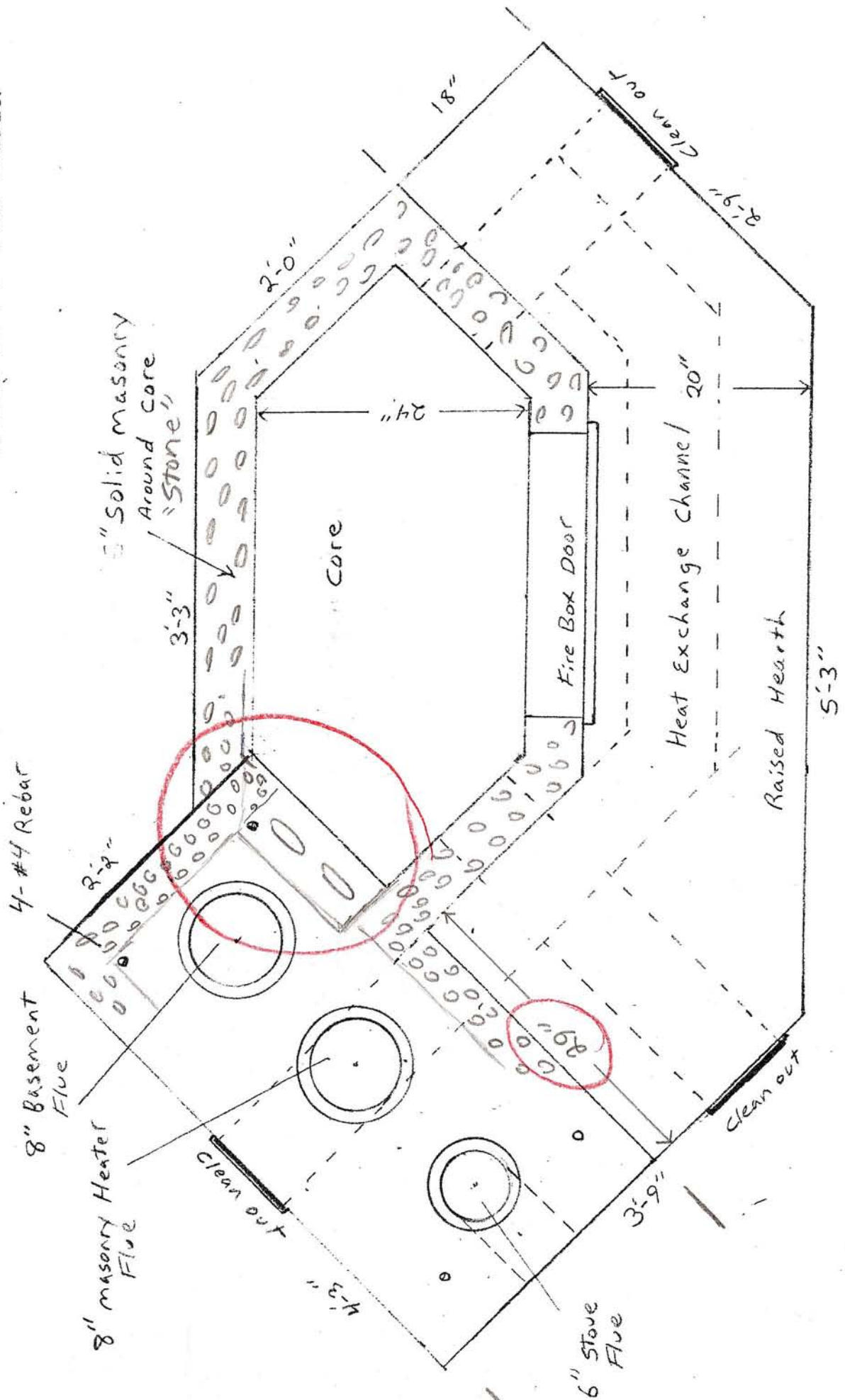

1"=1'

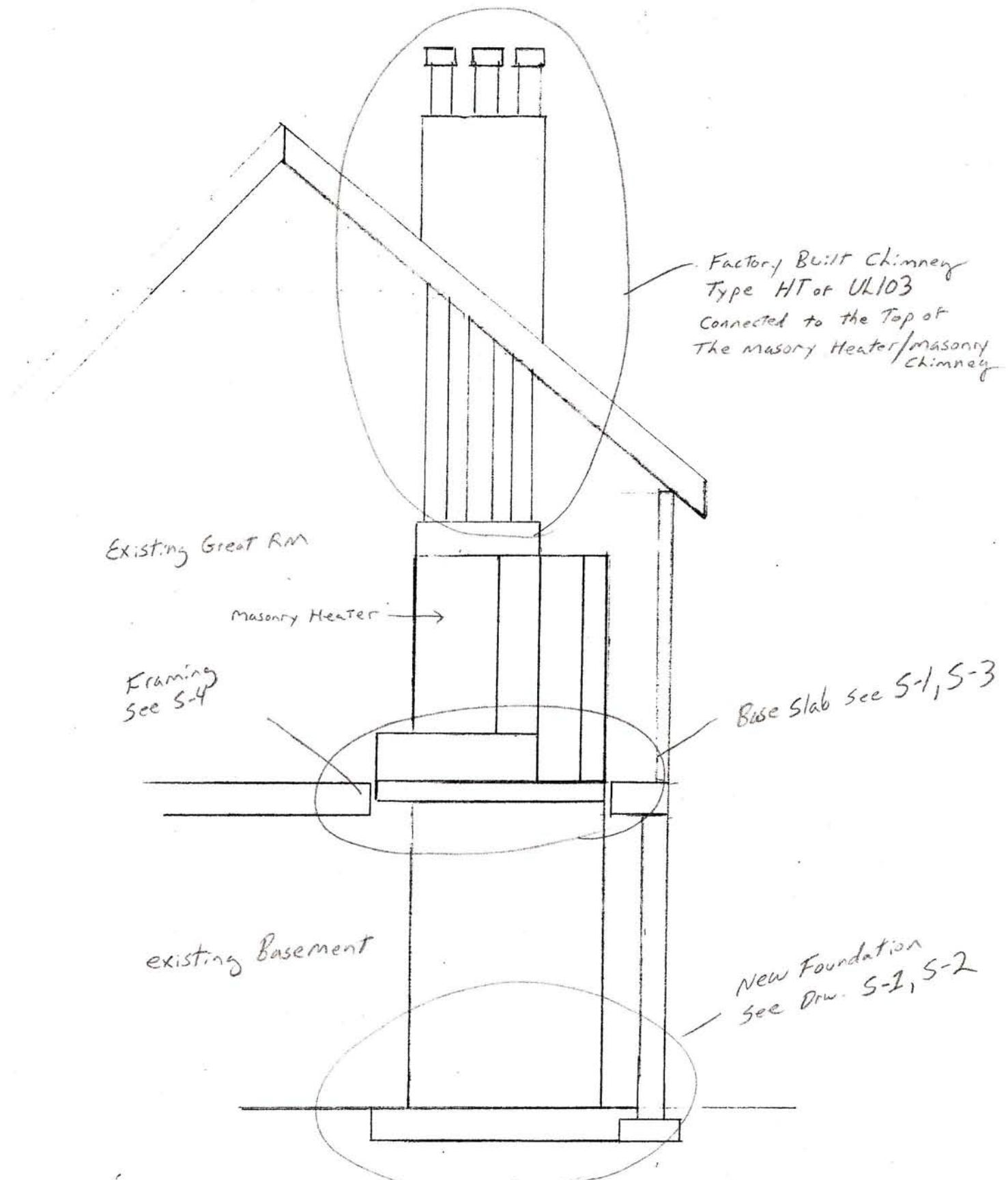

Factory Built Chimney
Type HT or UL103
Connected to the Top of
The masonry Heater/masonry
Chimney

Existing Great Rm

Masonry Heater →

Framing
See S-4

Base Slab see S-1, S-3

existing Basement

New Foundation
See Draw. S-1, S-2

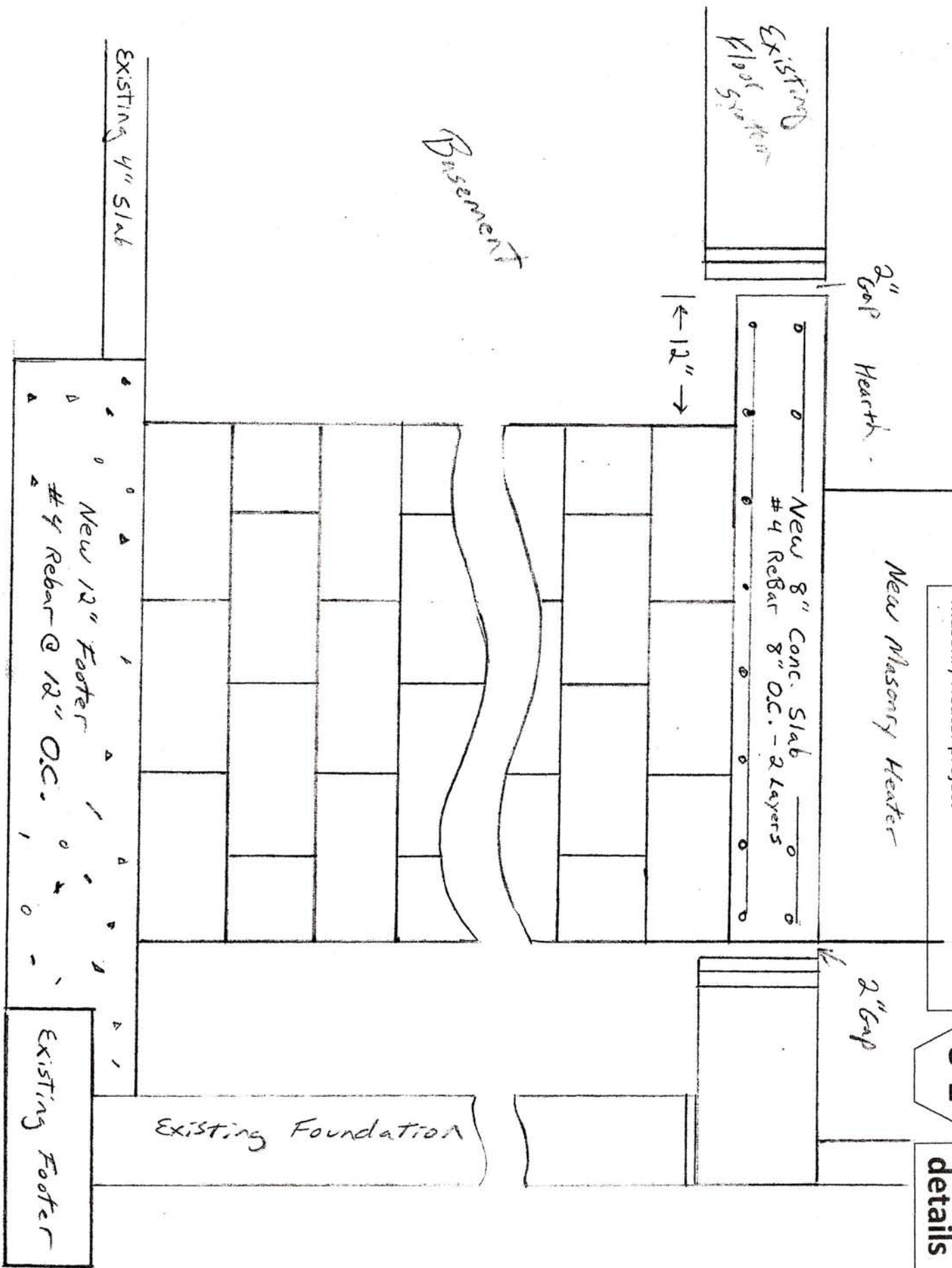

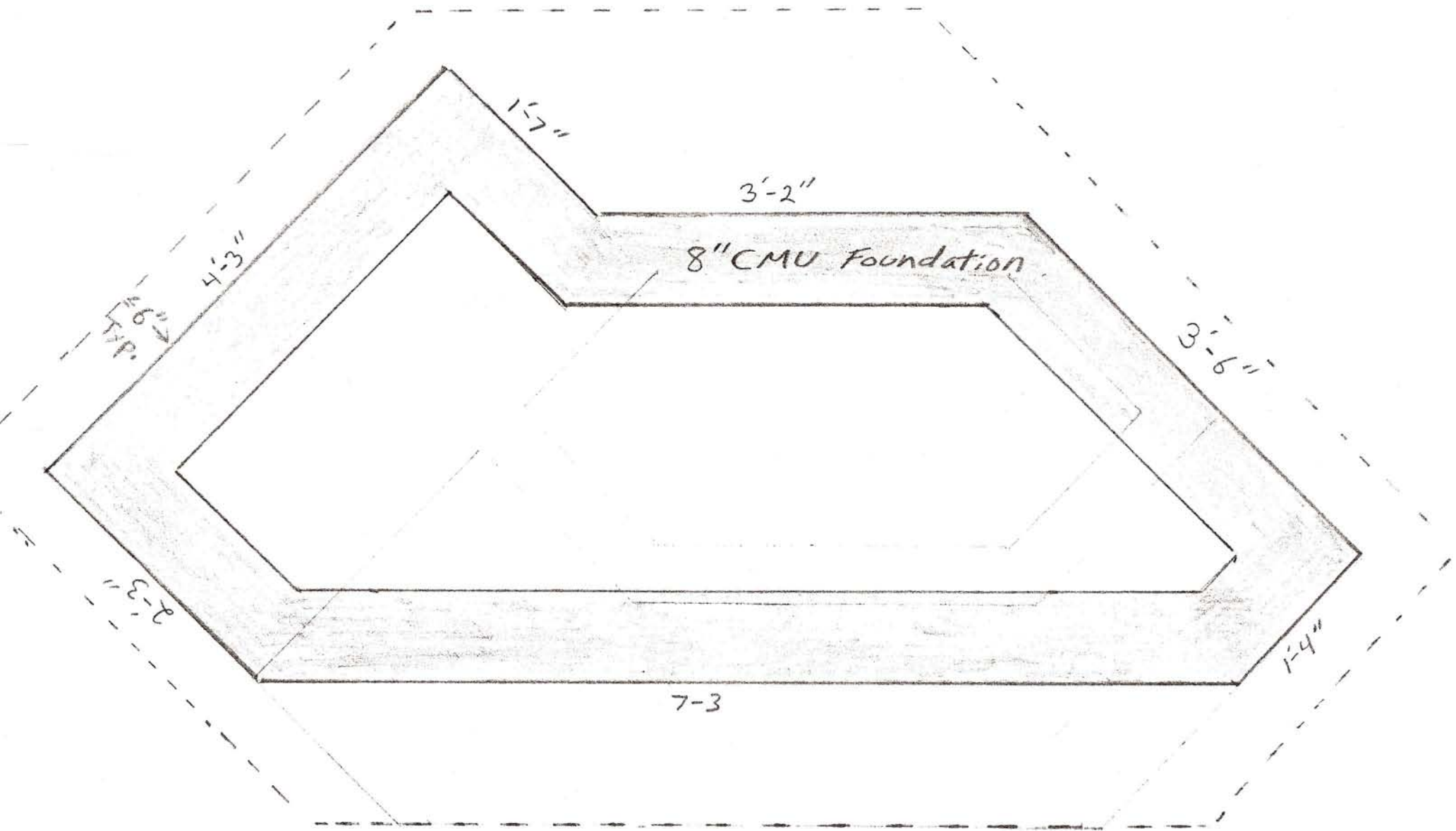

12" deep Conc. footer
#4 Rebar @ 12" OC.

Masonry heater
base slab detail

S-3

Masonry Heater project

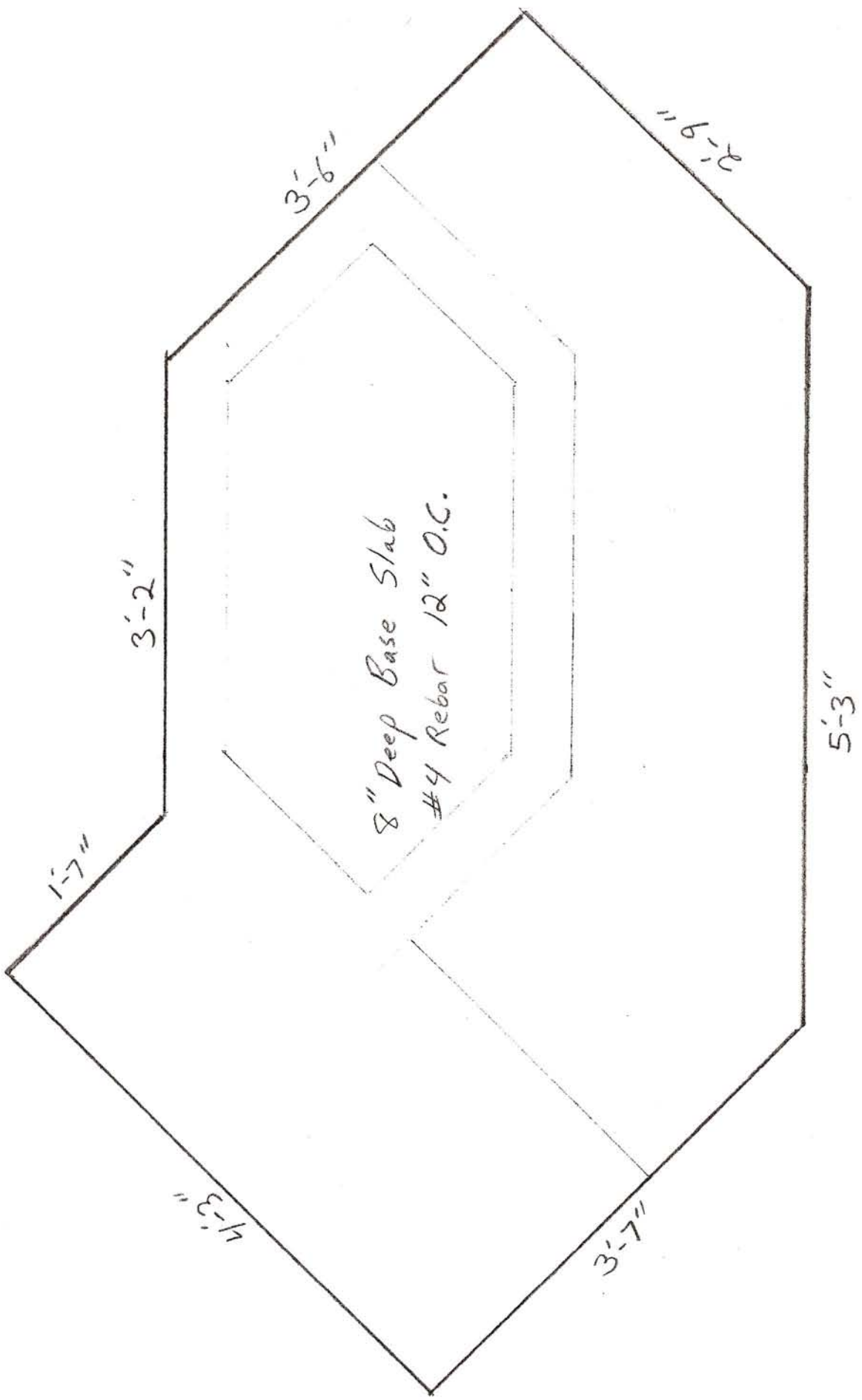

Floor framing
details

S-4

Masonry Heater project
12125 Shaper Road, Owings, MD 20750

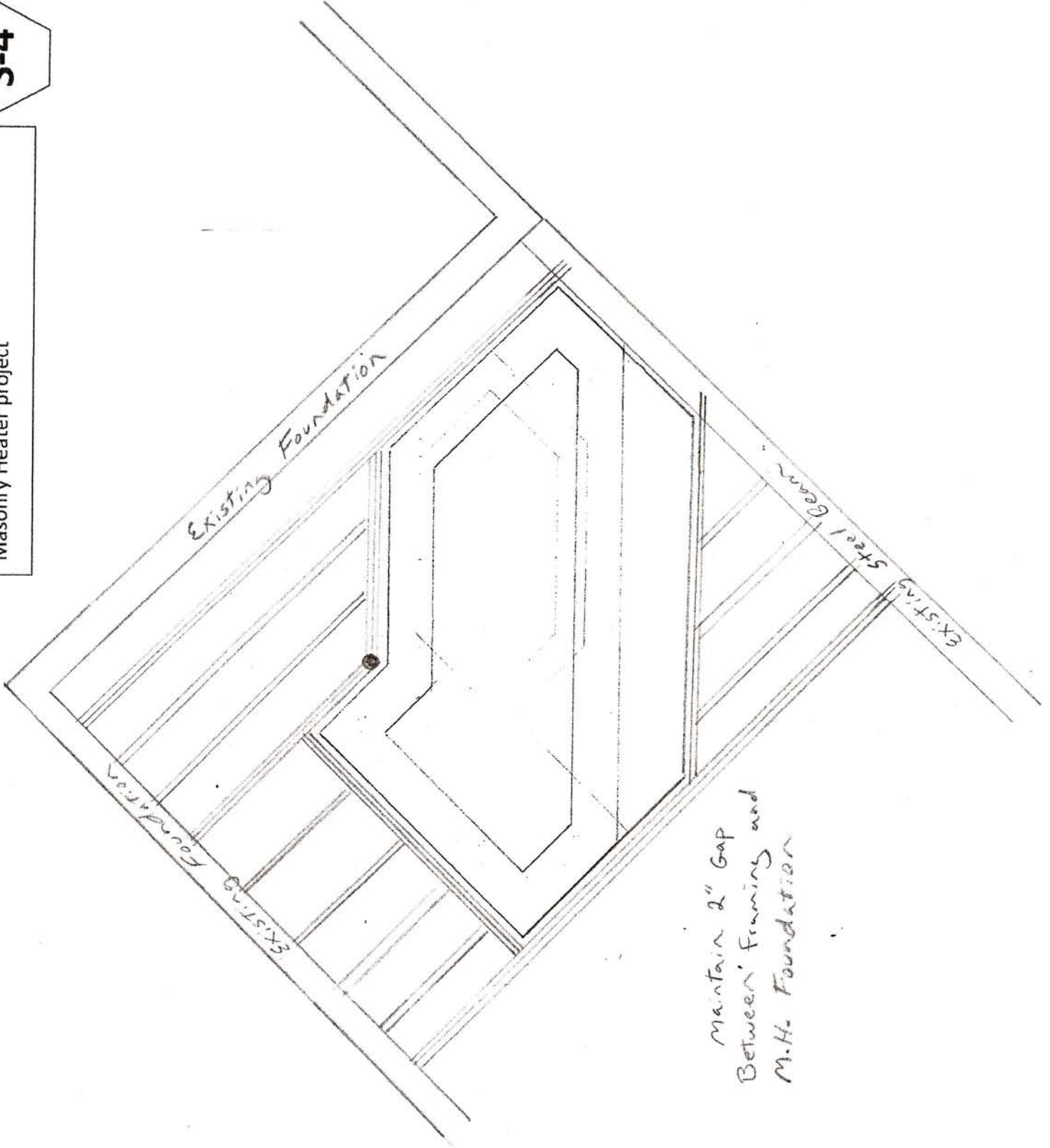

Maintain 2" Gap
Between Framing and
M.H. Foundation