

Russian Bake Oven

February 20, 2004

This is an interesting design. It has a separate firebox to fire the oven. The flue gases exit inside the oven, and are used for heating. So, this is a masonry heater also.

An interesting adaptation of this design would be to use the exiting flue gases to heat the hearth slab only, and to insulate the oven.



Рис. 13, а. Вид печи «Теплушка-2» спереди и разрез по Ж — Ж (см. рис. 12, а и б).



Рис. 13, б. Вид печи «Теплушка-2» сбоку и разрез по Д — Д (см. рис. 12, а и б).

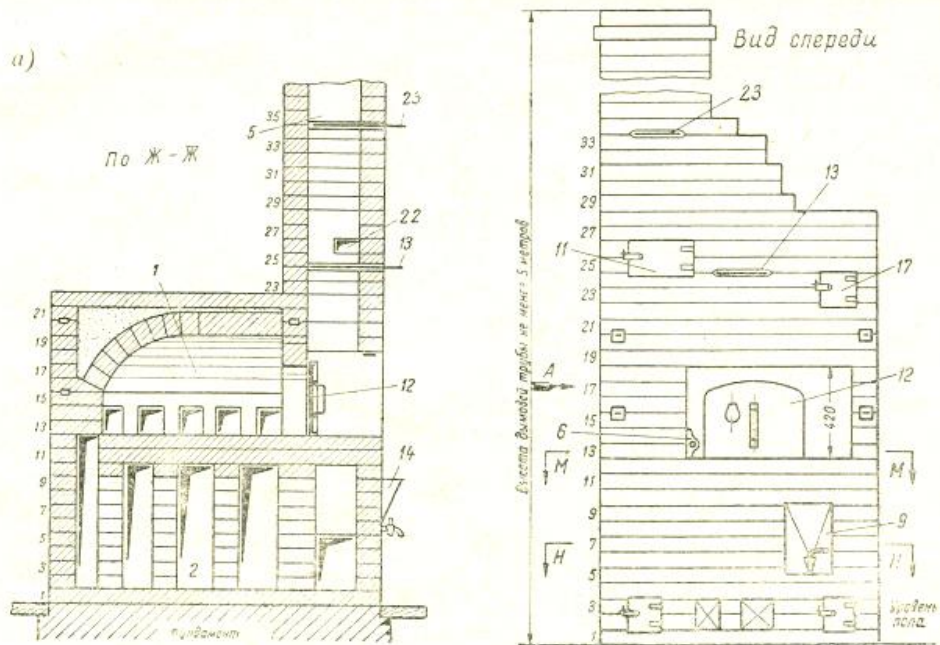

Рис. 14, а. Разрезы печи по А-А, Б-Б, В-В (см. рис. 12, а и б).

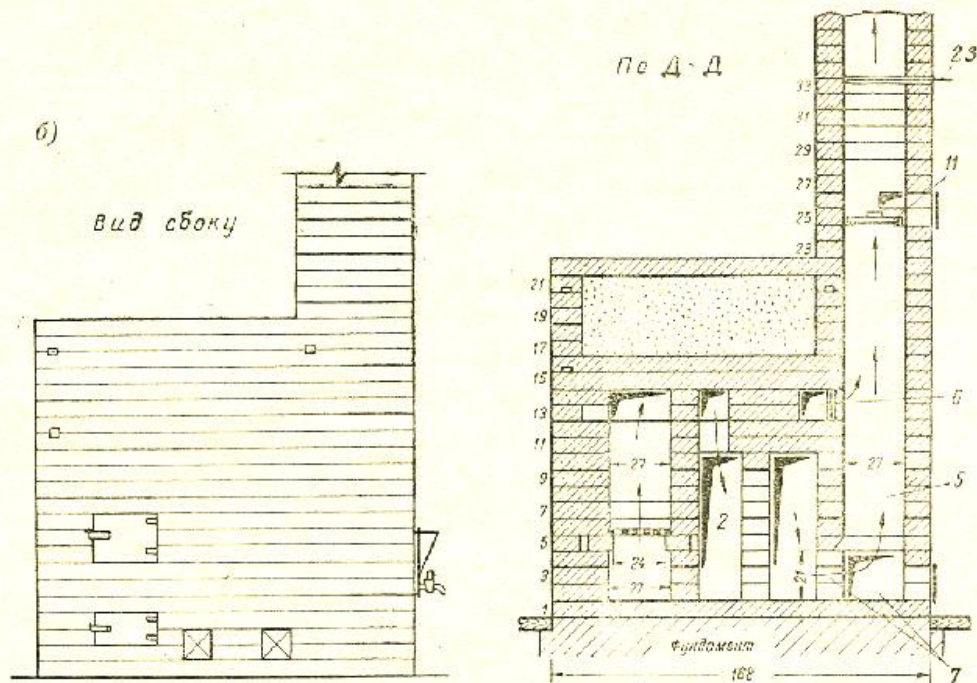

Рис. 14, б. Разрезы печи по Г-Г, И-И (см. рис. 12, а и б).

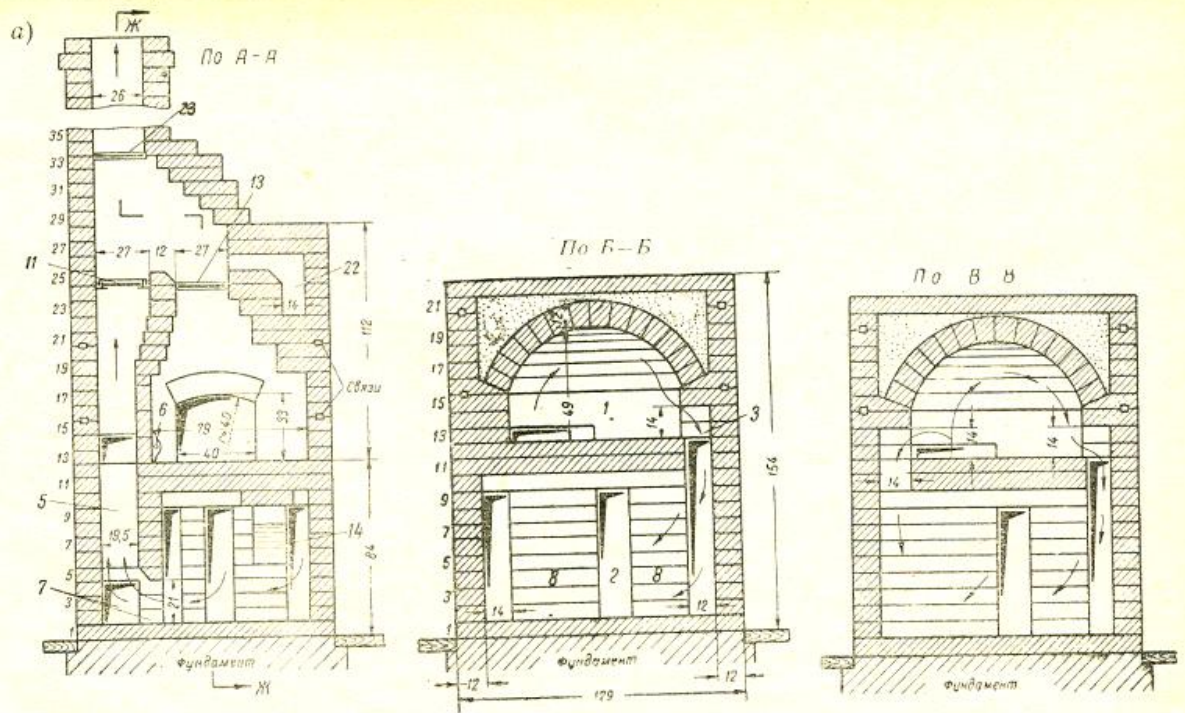

Рис. 16. Кладка 2-го ряда.

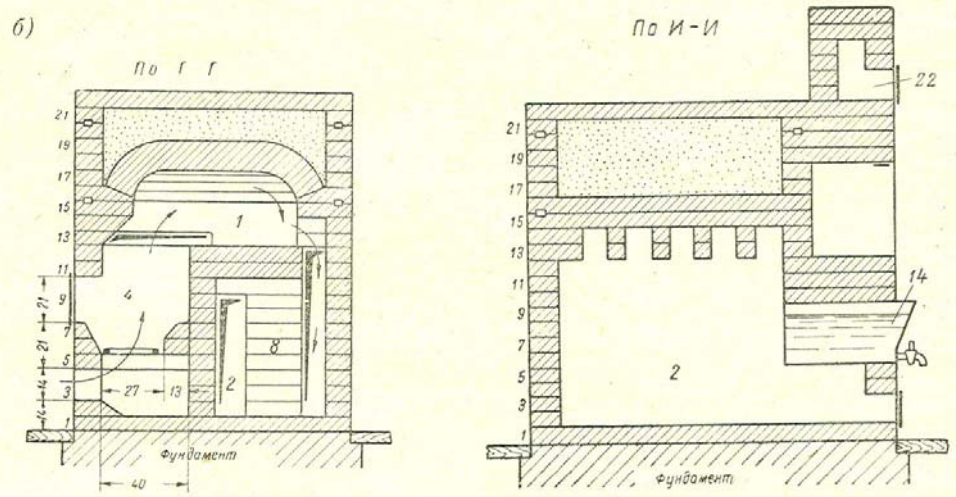

Рис. 17. Кладка 3-го ряда.

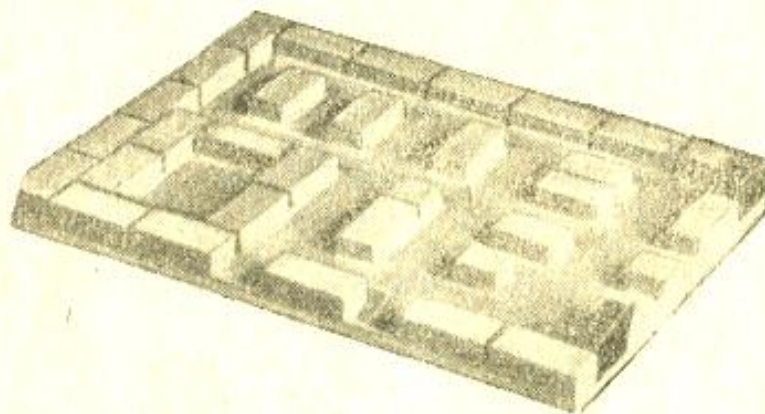
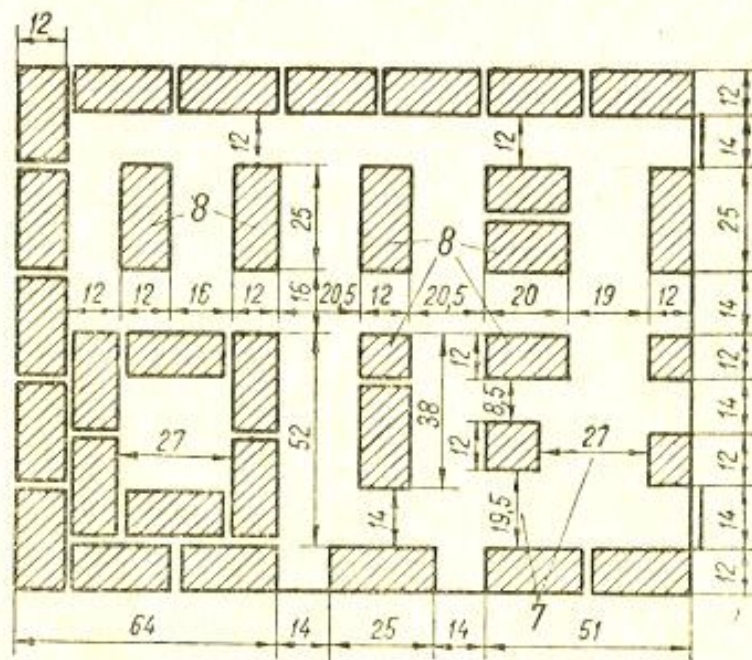

Рис. 20. Кладка 6-го ряда.

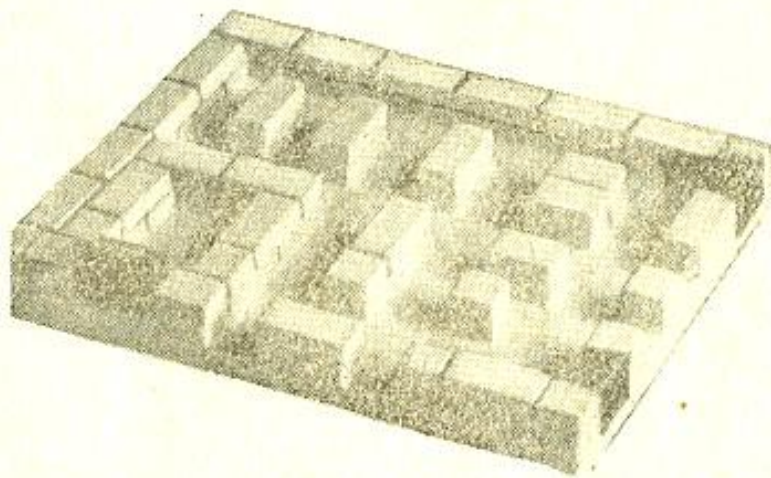
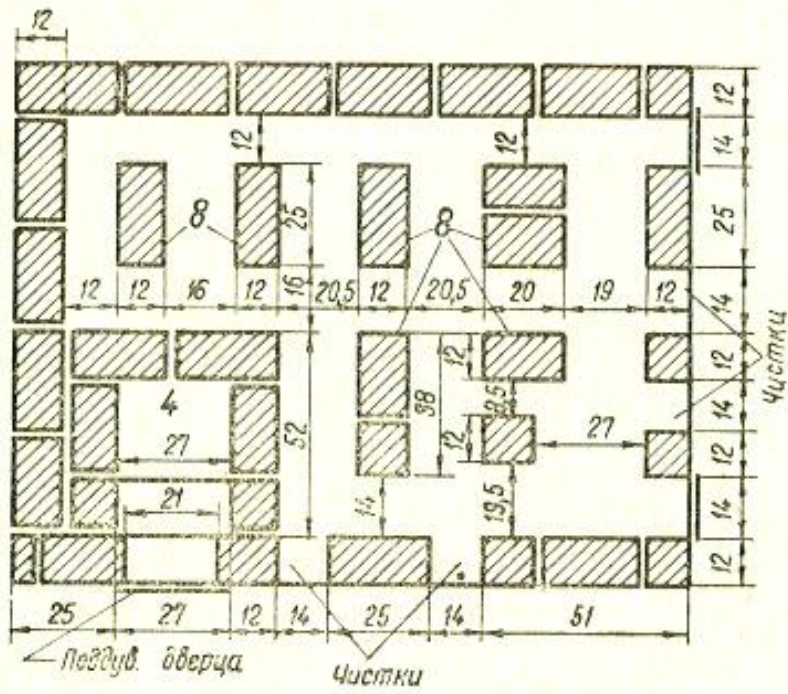

Рис. 21. Кладка 7-го ряда.

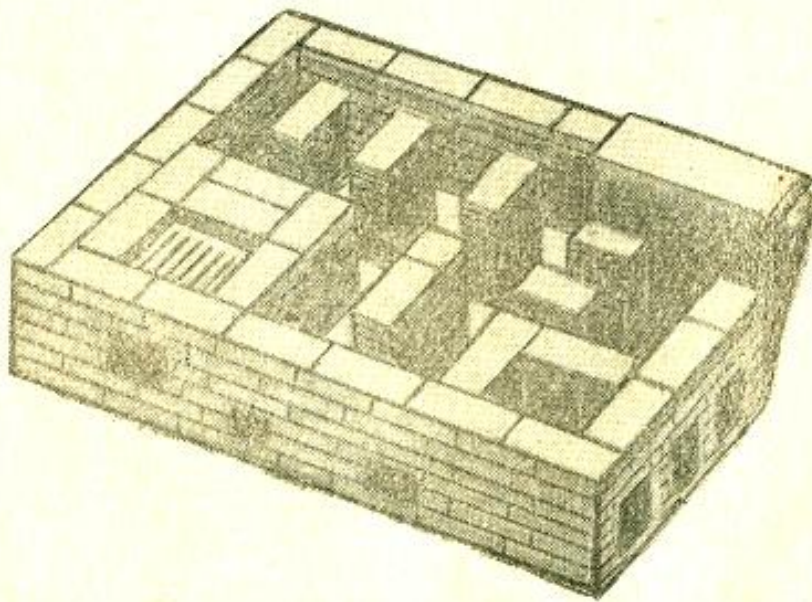
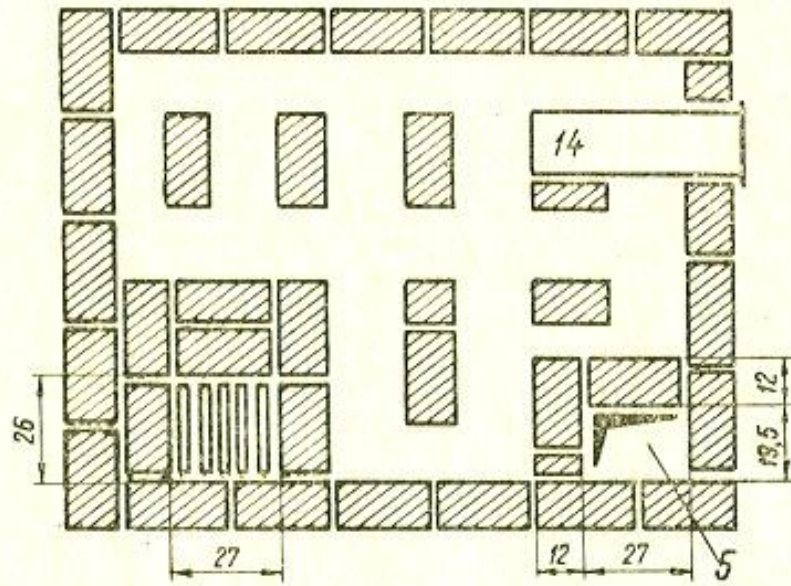

Рис. 22. Кладка 8-го ряда.

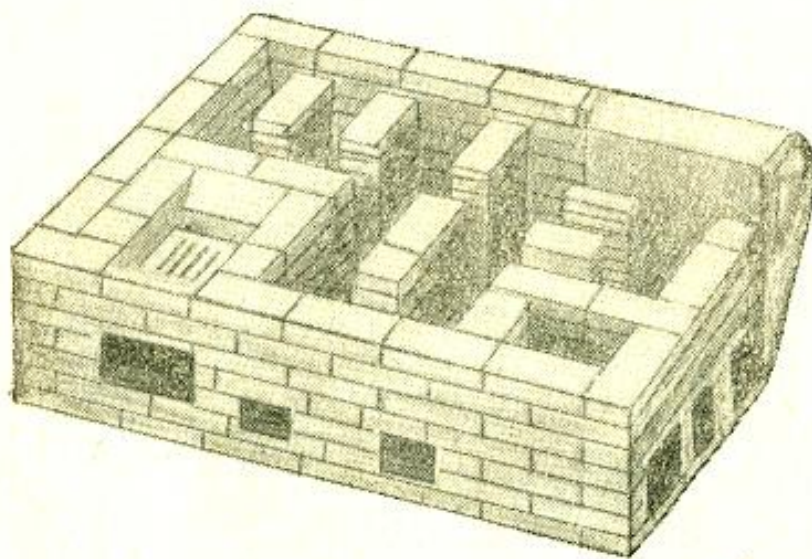
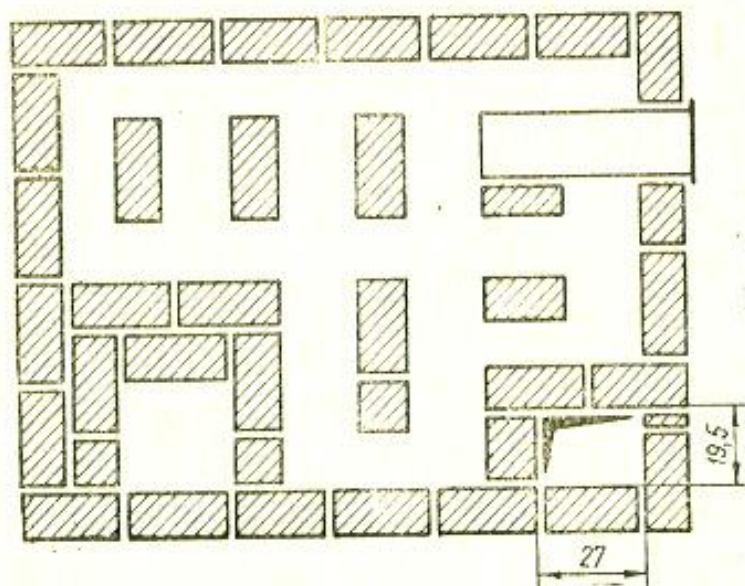

Рис. 23. Кладка 9-го ряда.

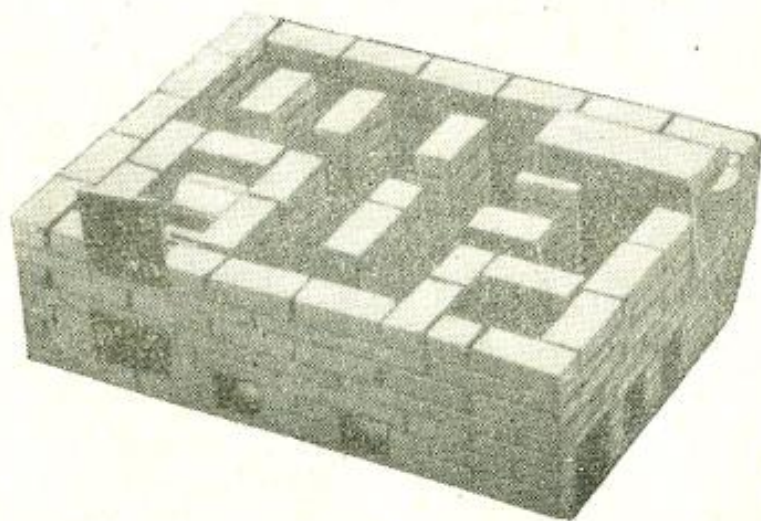
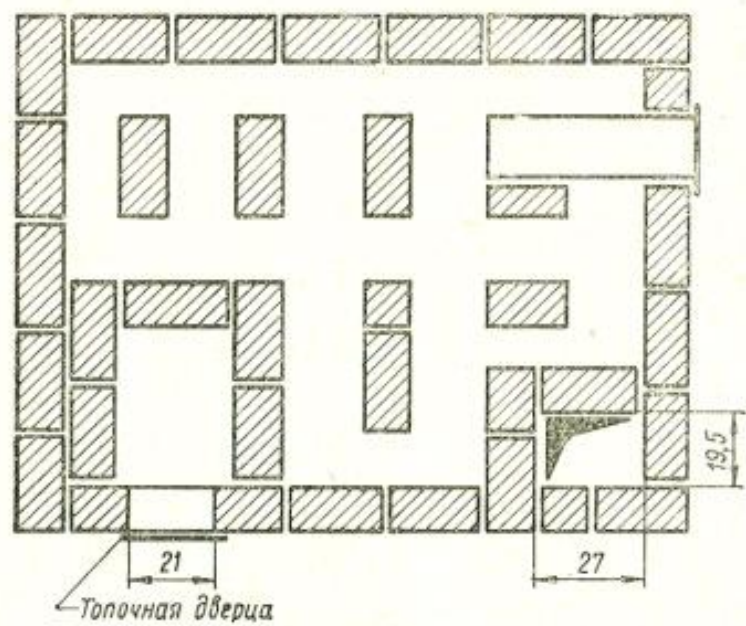

Рис. 24. Кладка 10-го ряда.

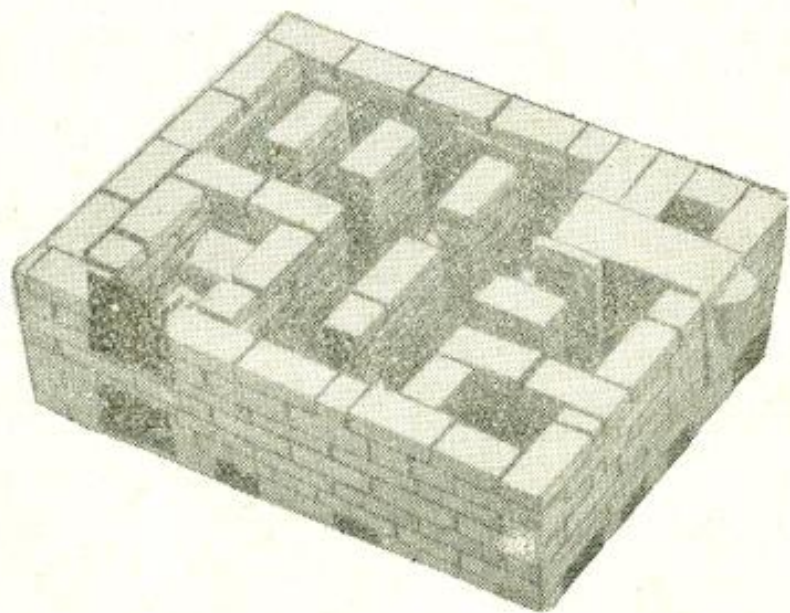
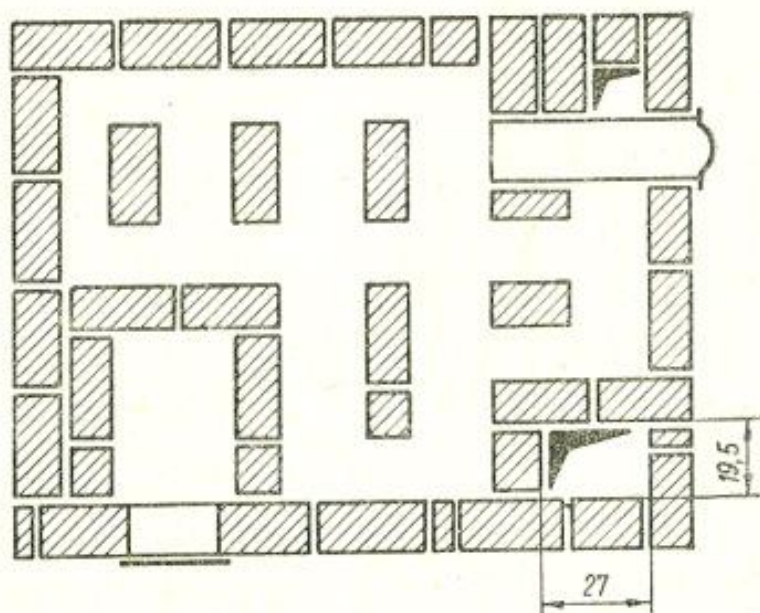

Рис. 25. Кладка 11-го ряда.

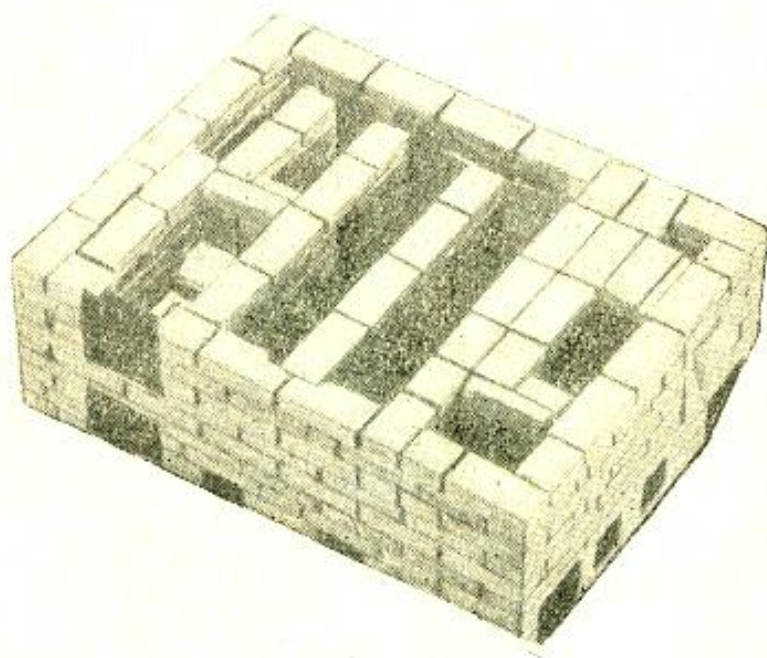
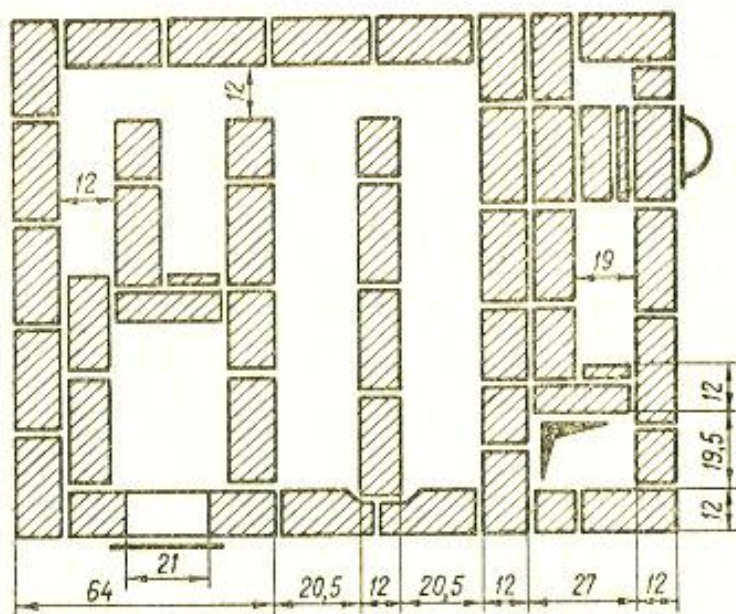

Рис. 26. Кладка 12-го ряда.

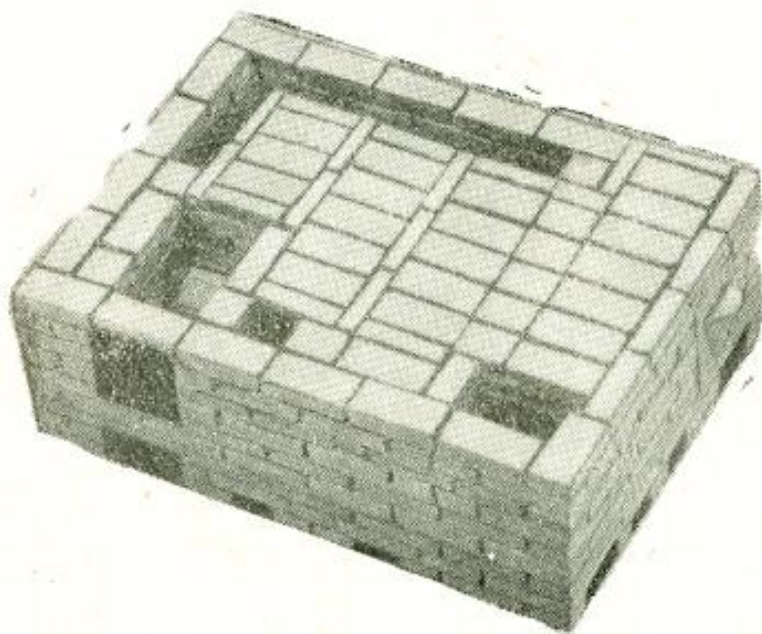
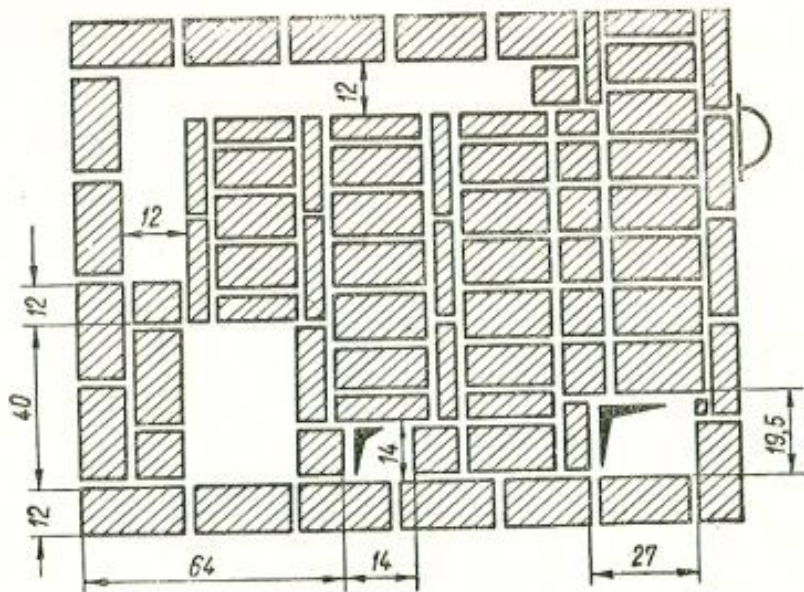

Рис. 27. Кладка 13-го ряда.

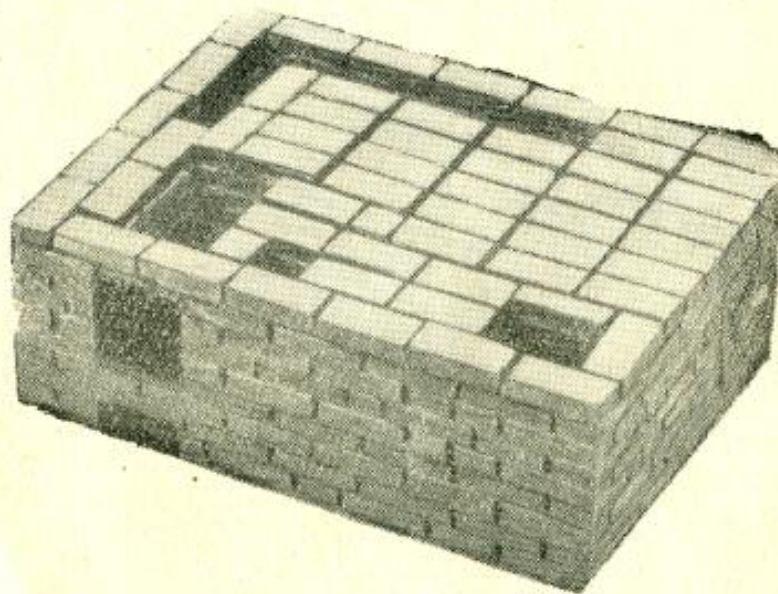
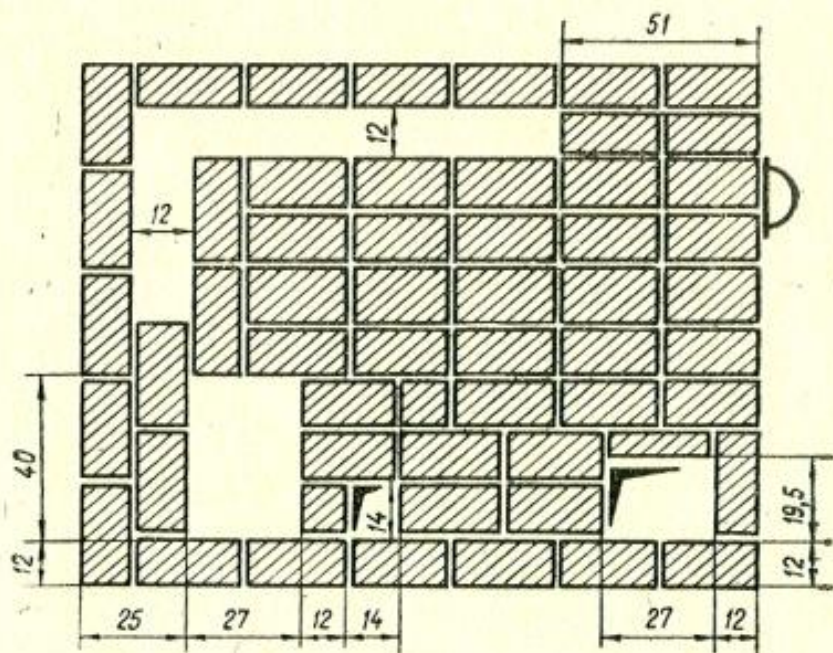

Рис. 27 Кладка 14-го ряда.

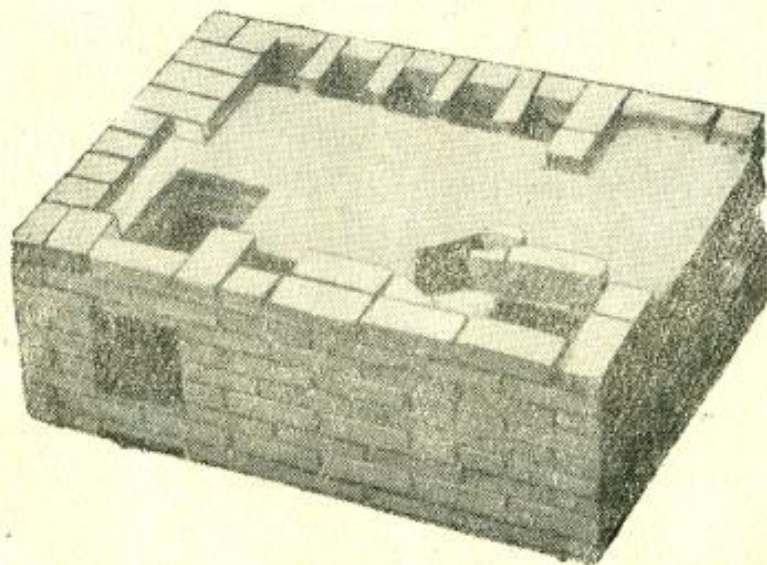
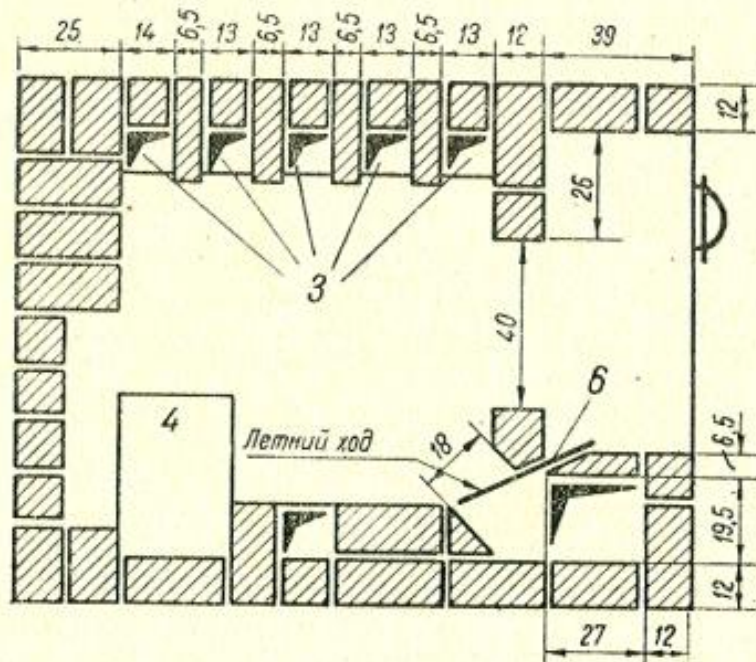

Рис. 99. Кладка 15-го ряда.

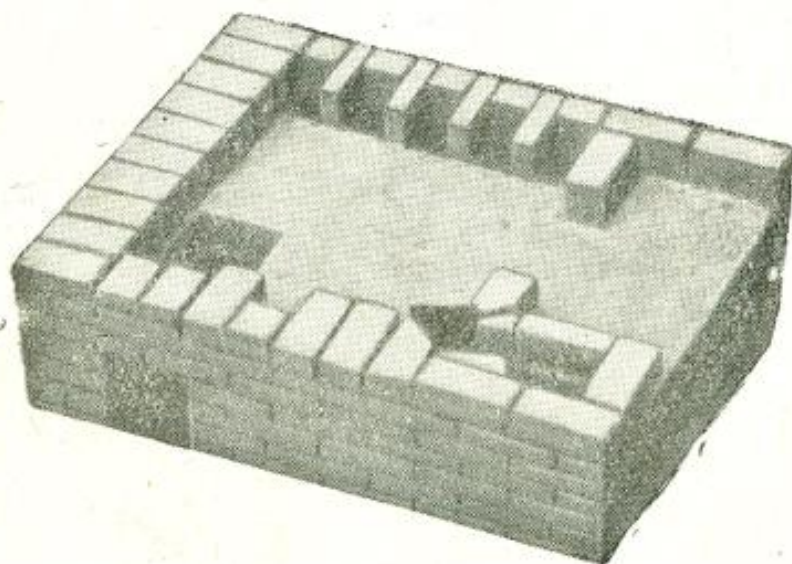
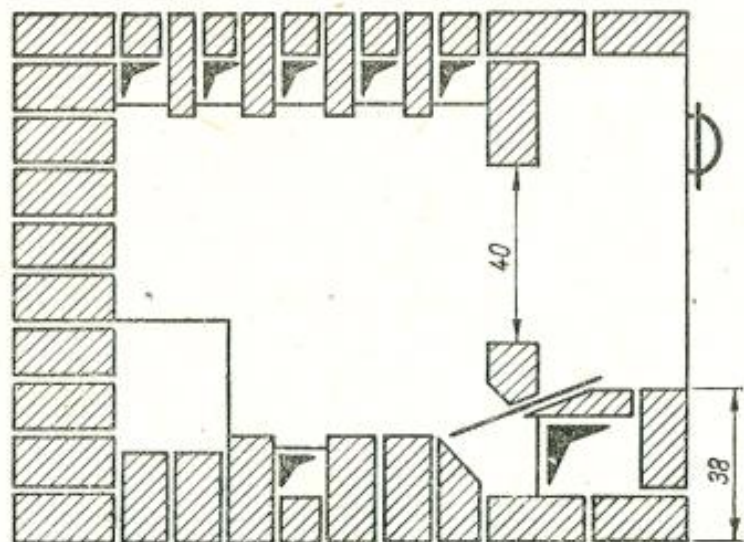

Рис. 30. Кладка 16-го ряда.

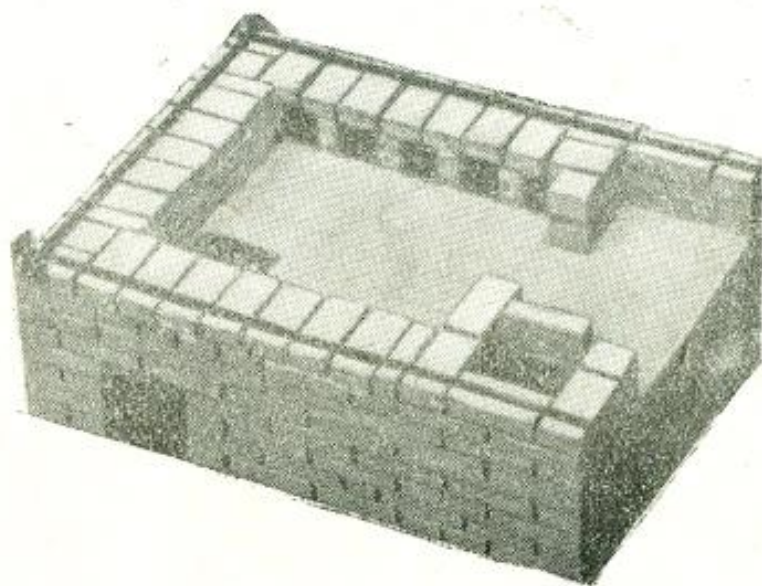
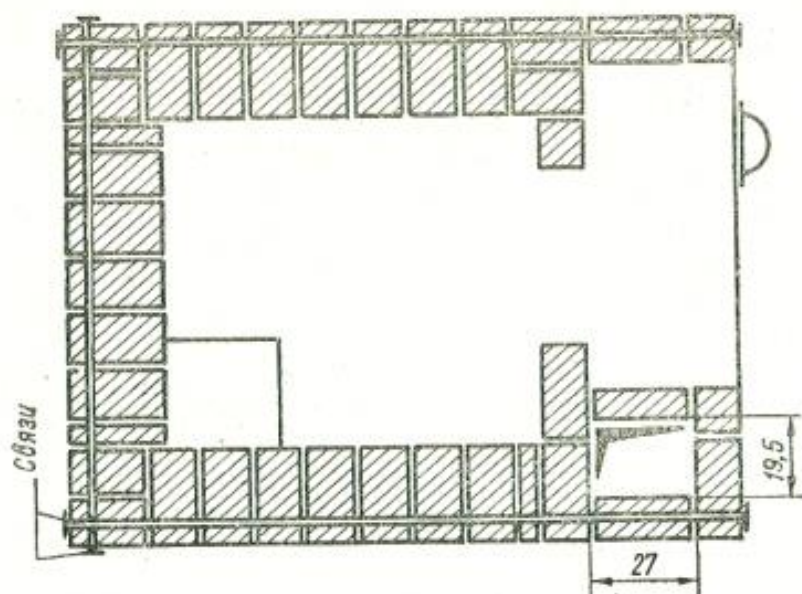

Рис. 31. Кладка 17-го ряда.

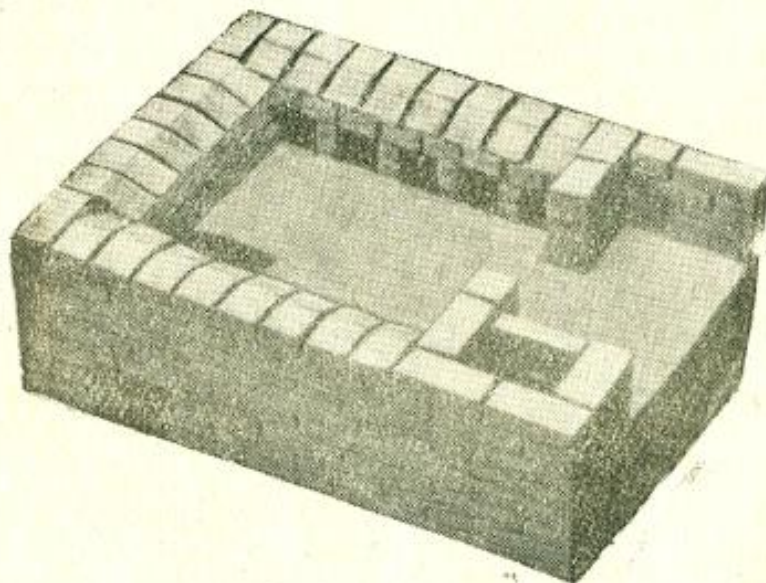
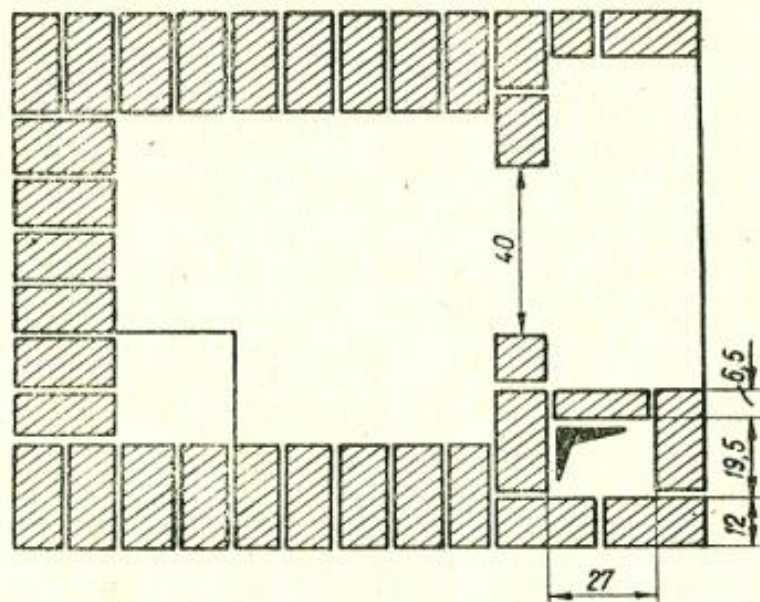

Рис. 32. Кладка 18-го ряда.

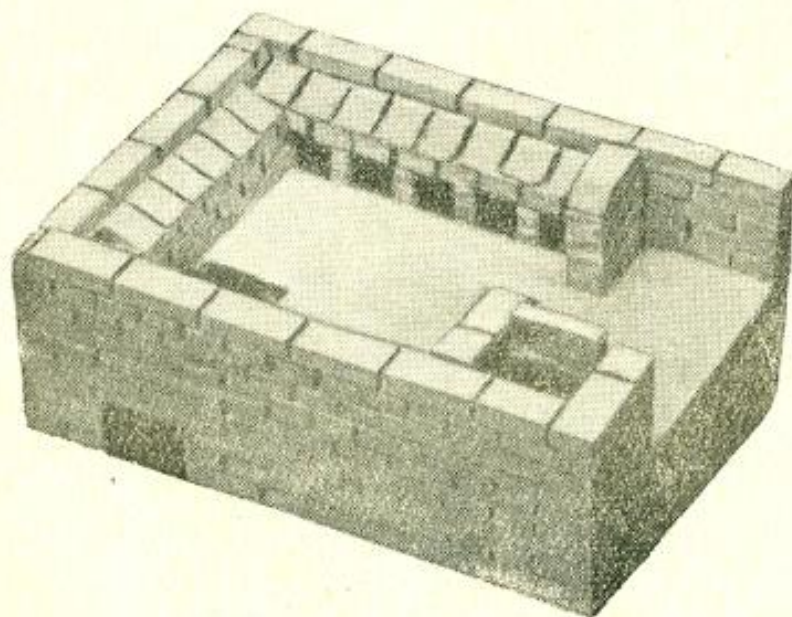
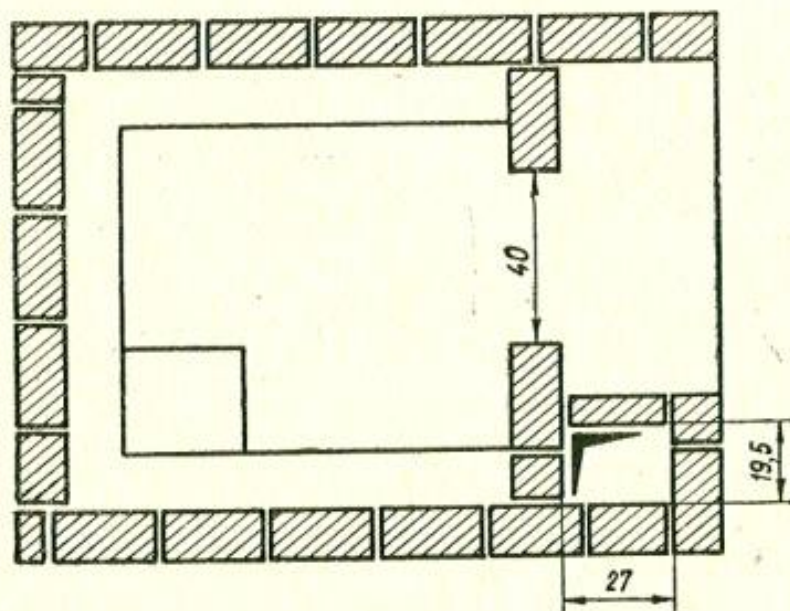

Рис. 33. Кладка 19-го ряда.

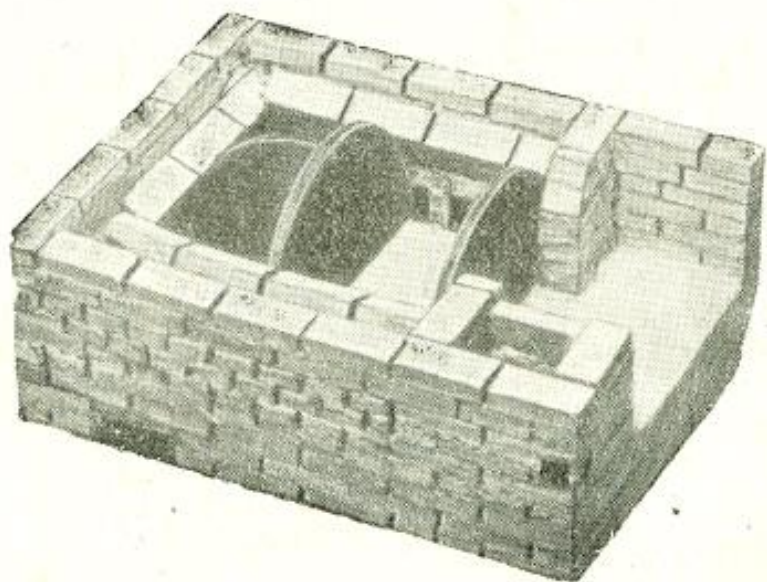
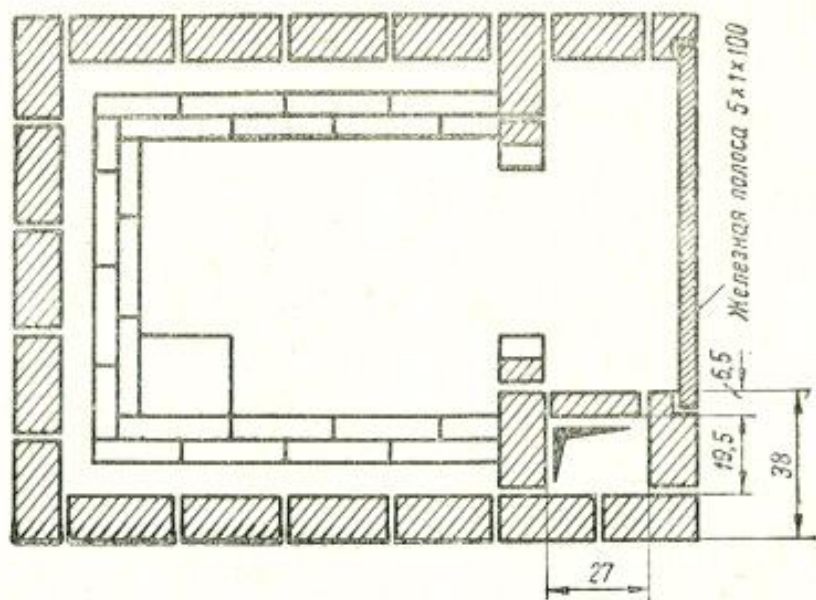

Рис. 34. Кладка 20-го ряда.

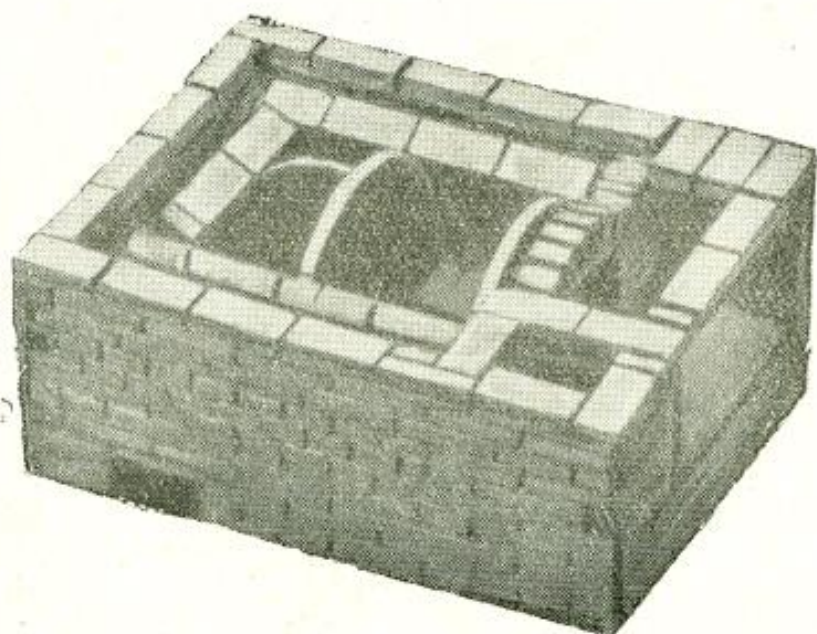
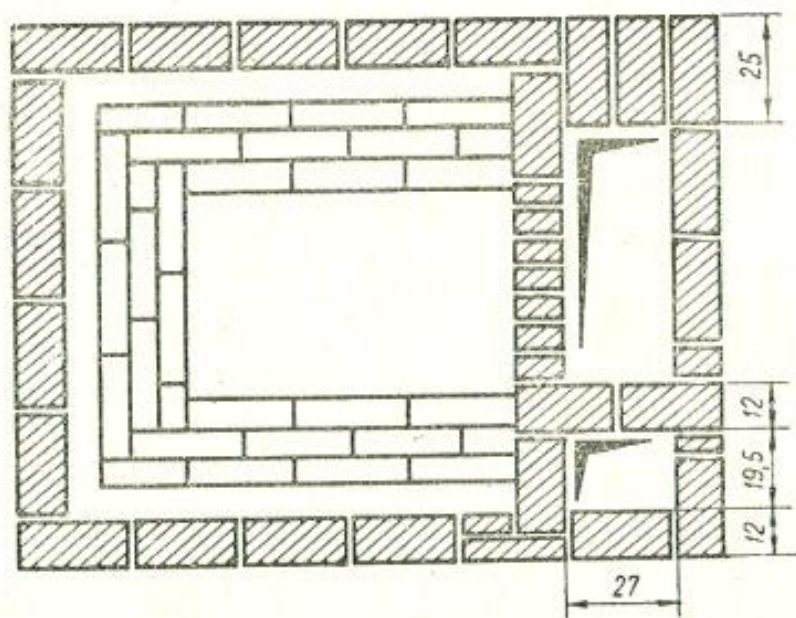

Рис. 35. Кладка 21-го ряда.

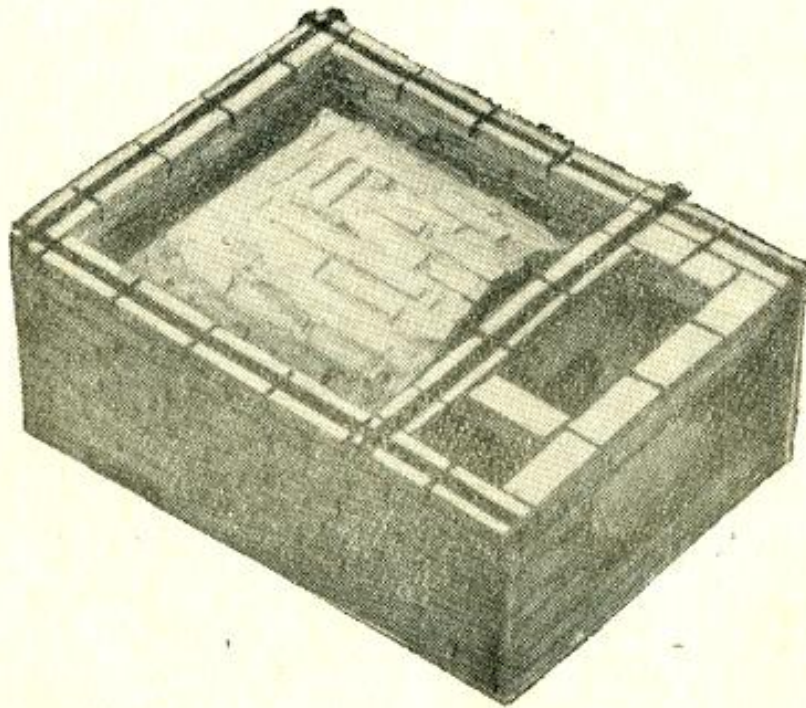
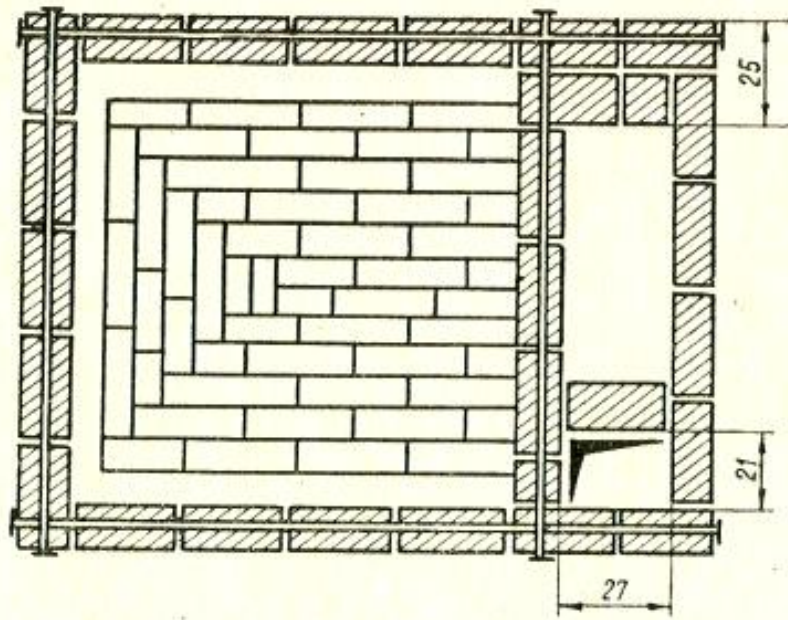

Рис. 36. Кладка 22-го ряда.

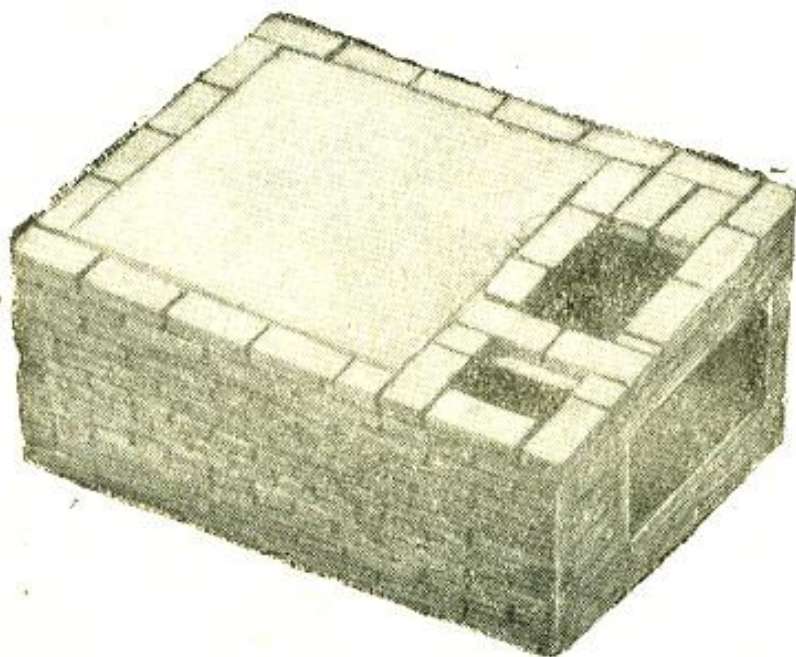
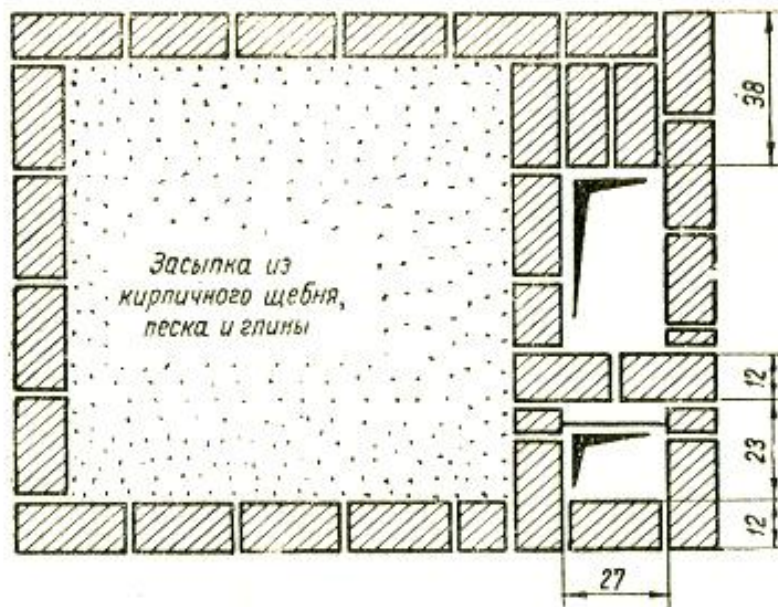

Рис. 37. Кладка 23-го ряда.

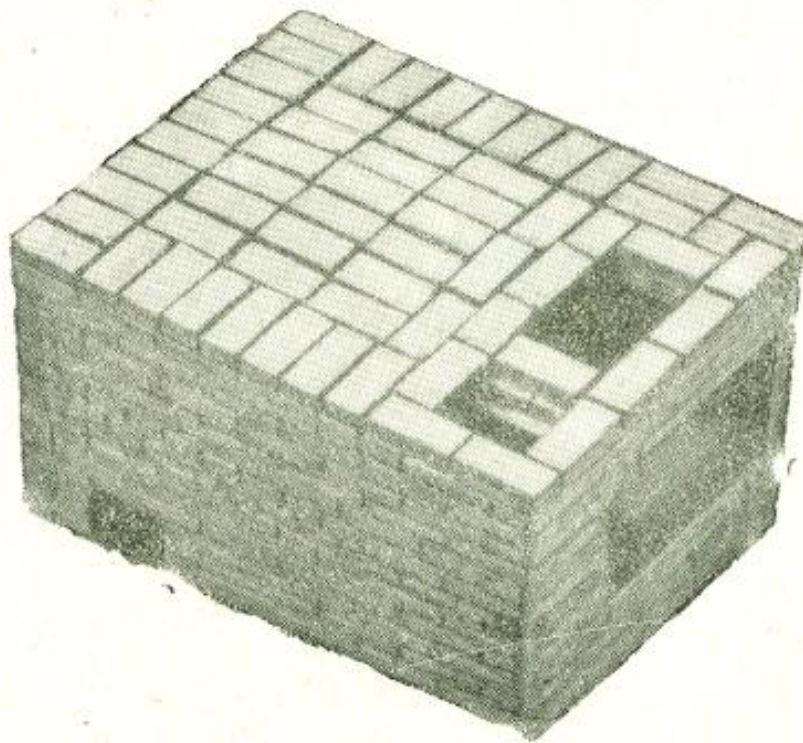
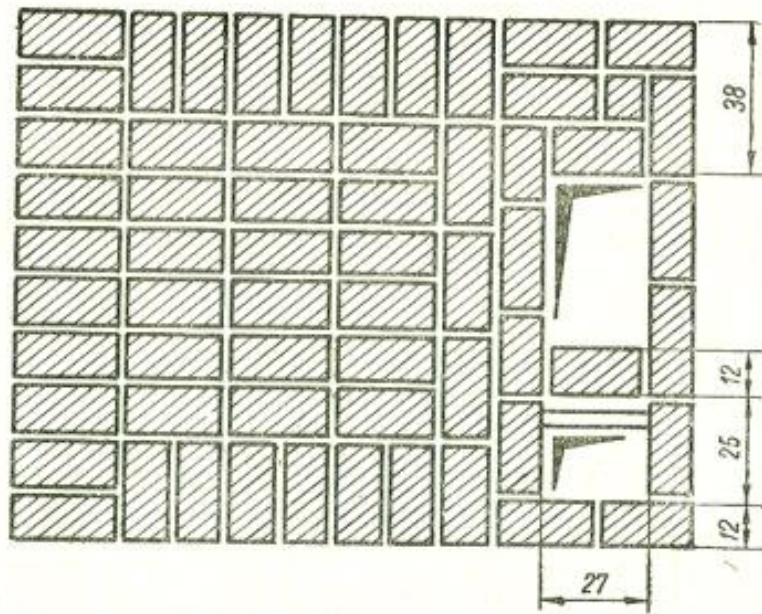

Рис. 38. Кладка 24-го ряда.

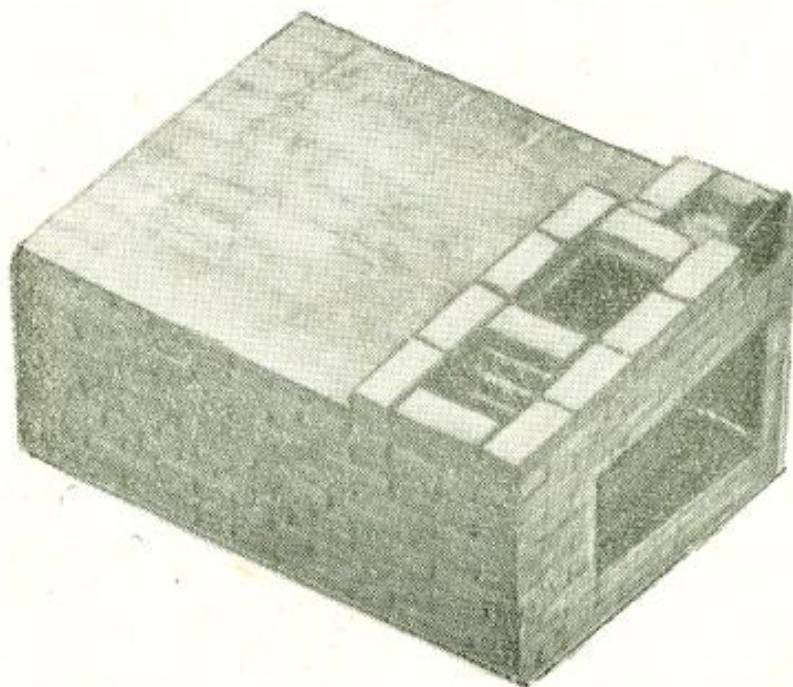
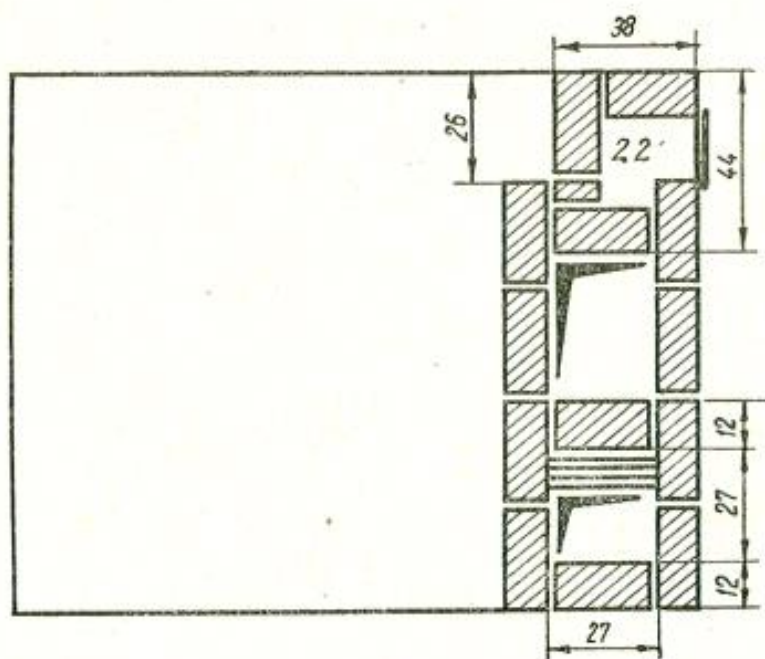

Дверца для вьюшки

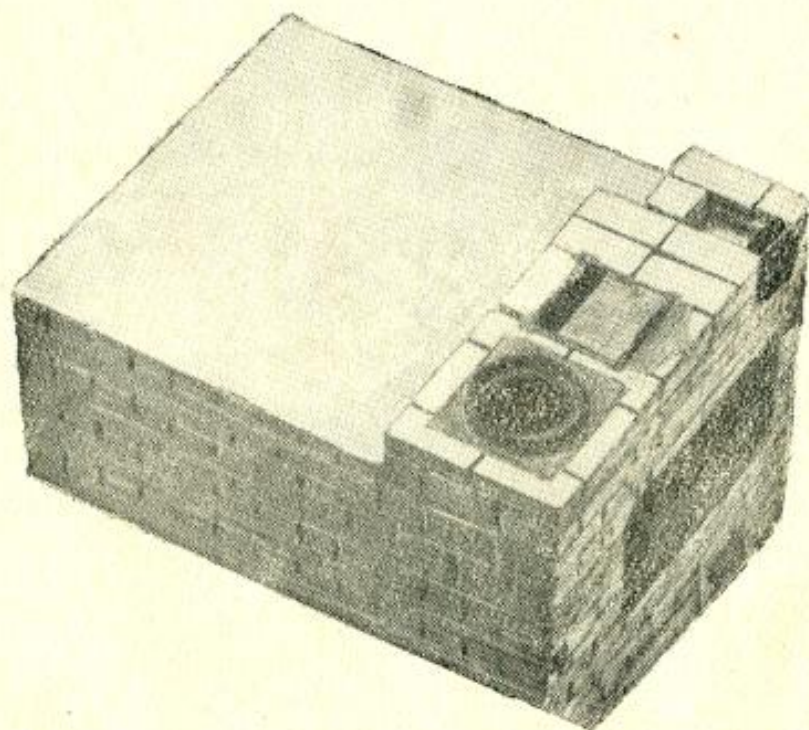
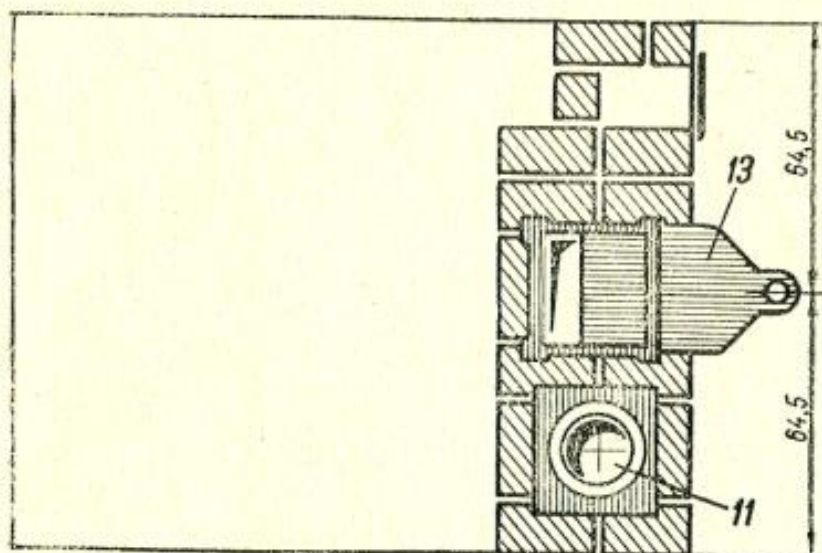
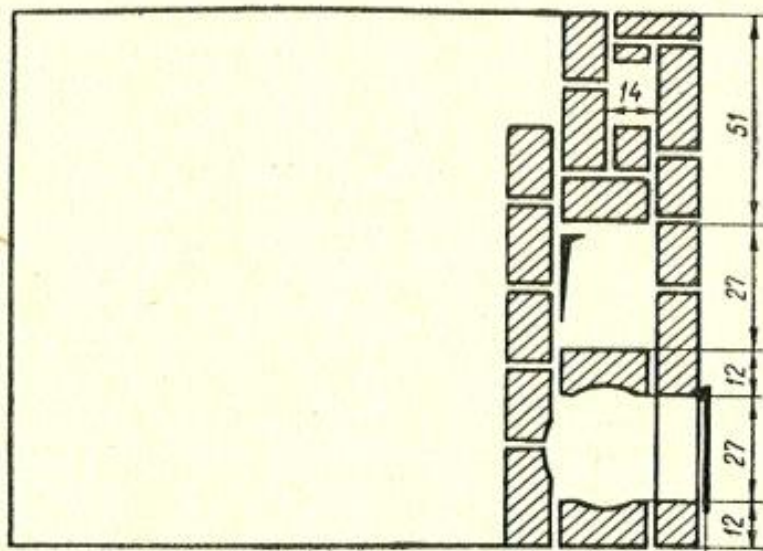

Рис. 39. Кладка 25-го ряда.



Рис. 40. Кладка 26-го ряда.

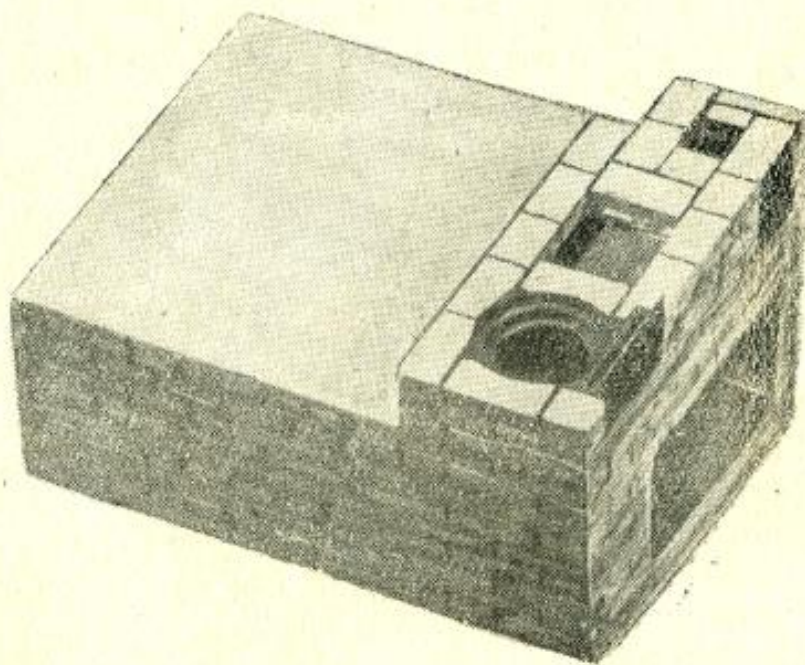

Рис. 41. Кладка 27-го ряда.

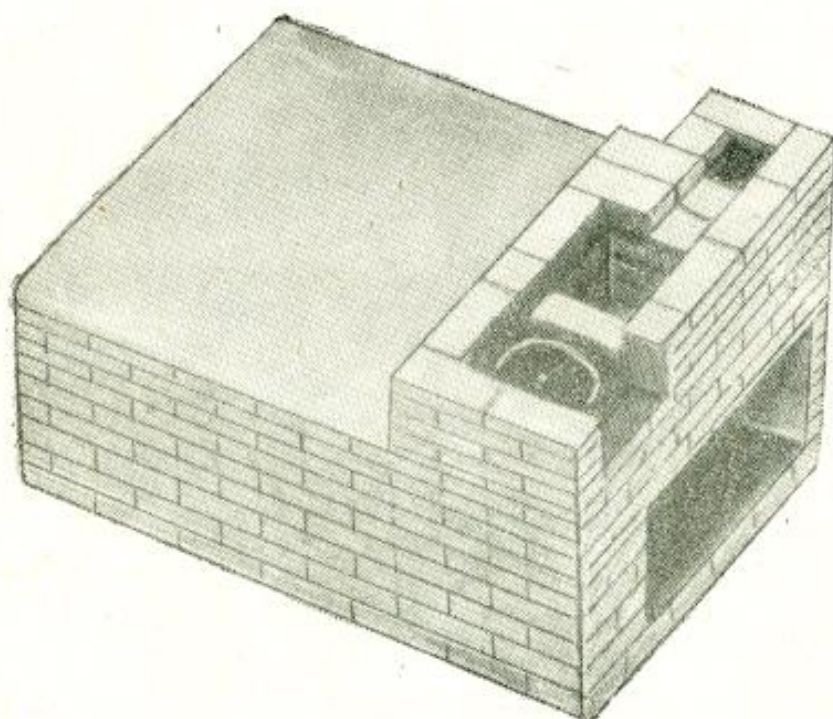
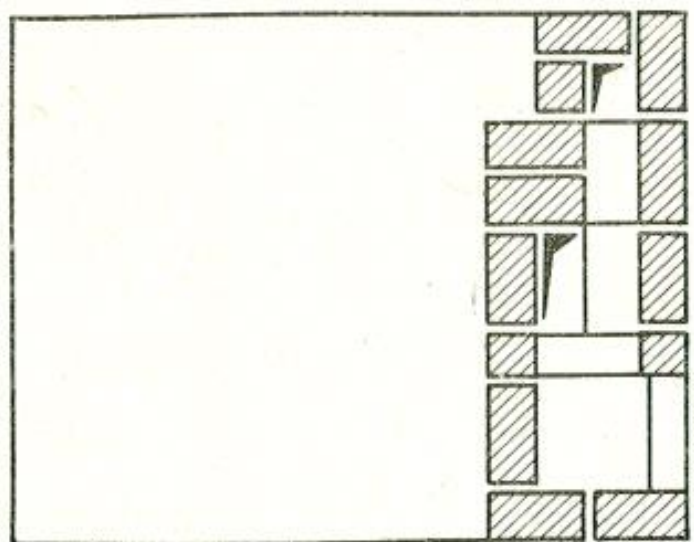

Рис. 42. Кладка 28-го ряда.

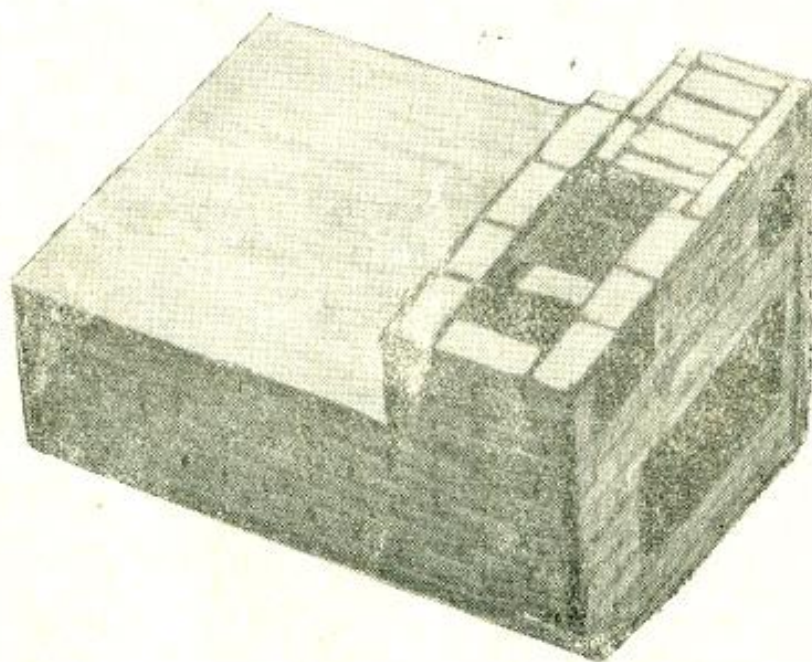
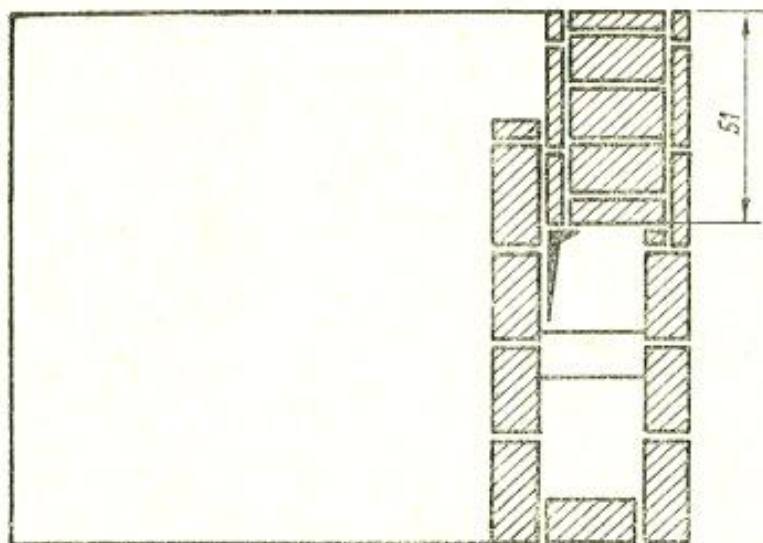
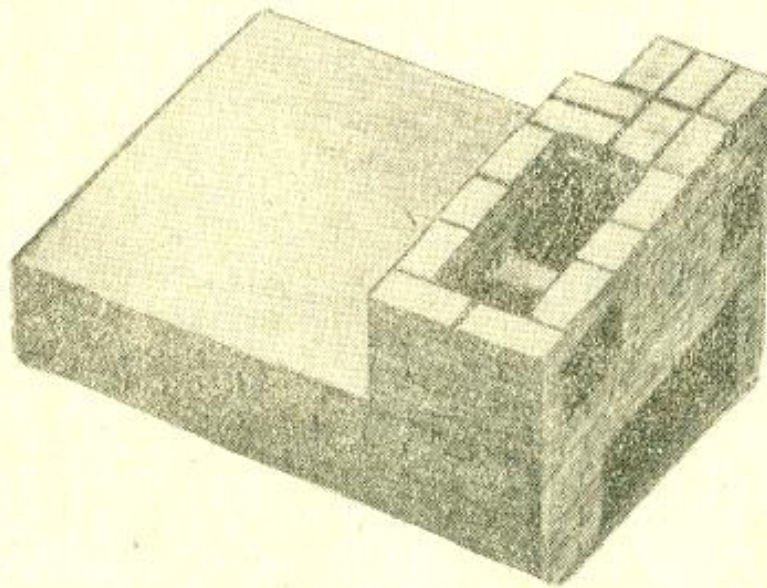
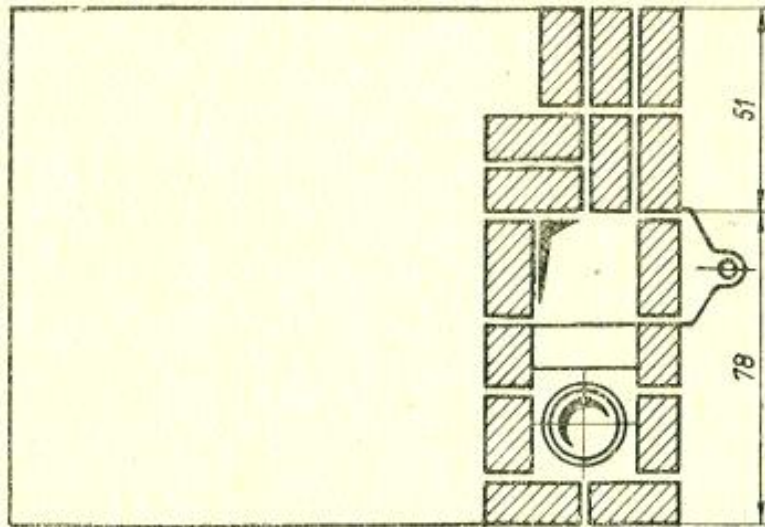
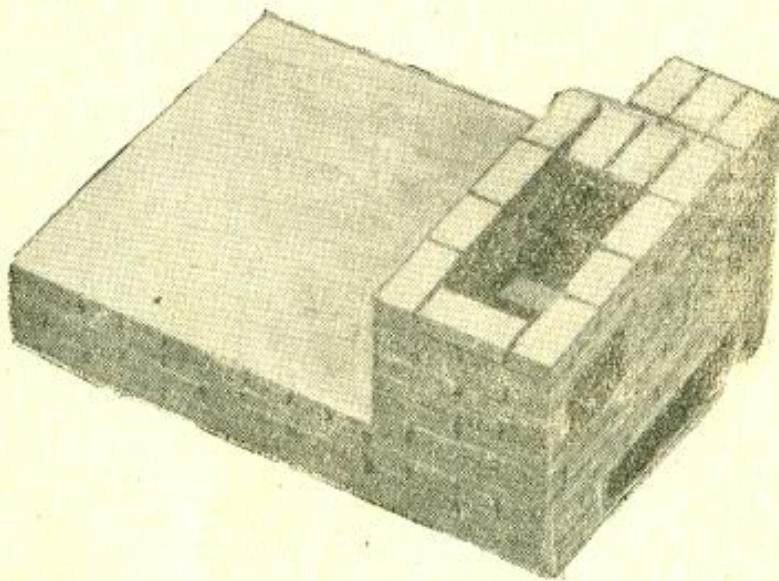
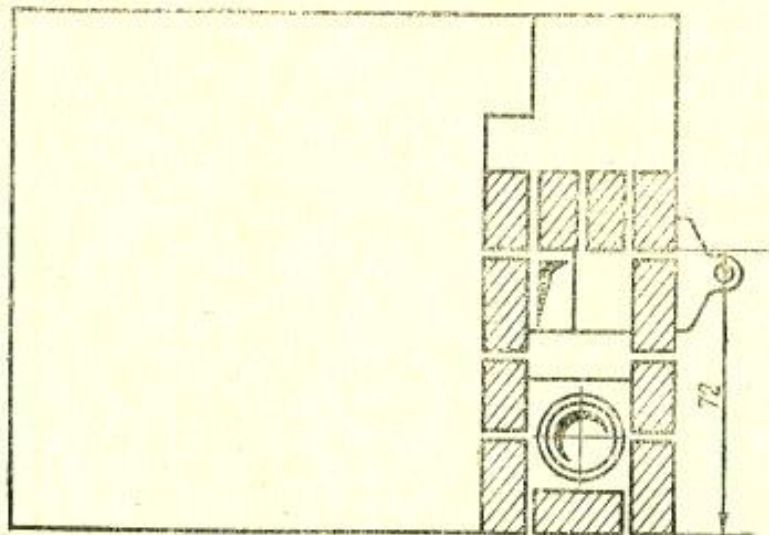

Рис. 43. Кладка 29-го ряда.